



Maryland Department of Planning  
Maryland Historical Trust

Martin O'Malley  
Governor

Anthony G. Brown  
Lt. Governor

Richard Eberhart Hall  
Secretary

Matthew J. Power  
Deputy Secretary

March 26, 2012

The Honorable Kevin Kamenetz  
County Executive, Baltimore County  
400 Washington Avenue  
Towson, Maryland 21401

RE: ANNESLIE HISTORIC DISTRICT  
Baltimore County, Maryland

Dear County Executive Kamenetz:

It is a pleasure to inform you that on March 12, 2012, Anneslie Historic District was entered into the National Register of Historic Places, a division of the National Park Service, U.S. Department of Interior. The Trust offers a certificate stating that the property is listed in the National Register. Please contact Jan Gowing at 410-514-7644, should you like a certificate prepared.

Do not hesitate to contact me should you have questions concerning the National Register program.

Sincerely,

Peter E. Kurtze  
Administrator  
Evaluation and Registration

PEK/jmg

cc: State Clearinghouse #MD20110929-0774

Hon. John Olszewski  
Mr. Martin P. Azola  
Ms. Karen Brown  
Mr. Mark Lewandowski  
Hon. James Brochin  
Hon. Susan L. M. Auman  
Hon. William J. Frank  
Hon. Stephen W. Lafferty

United States Department of the Interior  
National Park Service

# National Register of Historic Places Registration Form

This form is for use in nominating or requesting determinations for individual properties and districts. See instructions in *How to Complete the National Register of Historic Places Registration Form* (National Register Bulletin 16A). Complete each item by marking "x" in the appropriate box or by entering the information requested. If any item does not apply to the property being documented, enter "N/A" for "not applicable." For functions, architectural classification, materials, and areas of significance, enter only categories and subcategories from the instructions. Place additional entries and narrative items on continuation sheets (NPS Form 10-900a). Use a typewriter, word processor, or computer, to complete all items.

## 1. Name of Property

historic name Anneslie Historic District

other names (BA-3200)

## 2. Location

street & number Roughly bounded by York Rd., Register Ave., Maplewood Rd. and Windwood Rd.  not for publication

city or town Towson  vicinity

state Maryland code MD county Baltimore code 005 zip code 21212

## 3. State/Federal Agency Certification

As the designated authority under the National Historic Preservation Act of 1966, as amended, I hereby certify that this  nomination  request for determination of eligibility meets the documentation standards for registering properties in the National Register of Historic Places and meets the procedural and professional requirements set forth in 36 CFR Part 60. In my opinion, the property  meets  does not meet the National Register criteria. I recommend that this property be considered significant  nationally  statewide  locally. ( See continuation sheet for additional comments).

  
Signature of certifying official/Title

1-23-12  
Date

State or Federal agency and bureau

In my opinion, the property  meets  does not meet the National Register criteria. ( See continuation sheet for additional comments).

Signature of certifying official/Title

Date

State or Federal agency and bureau

## 4. National Park Service Certification

I hereby, certify that this property is:

entered in the National Register.

See continuation sheet.

determined eligible for the National Register.

See continuation sheet.

Determined not eligible for the National Register.

removed from the National Register.

other (explain): \_\_\_\_\_

Signature of the Keeper

Date of Action

\_\_\_\_\_  
\_\_\_\_\_  
\_\_\_\_\_  
\_\_\_\_\_

Anneslie Historic District (BA-3200)  
Name of Property

Baltimore County, MD  
County and State

**5. Classification**

**Ownership of Property**  
(Check as many boxes as apply)

**Category of Property**  
(Check only one box)

**Number of Resources within Property**  
(Do not include previously listed resources in the count)

- private
- public-local
- public-State
- public-Federal
- building(s)
- district
- site
- structure
- object

Contributing	Noncontributing	
477	28	buildings
		sites
		structures
		objects
477	28	Total

**Name of related multiple property listing**  
(Enter "N/A" if property is not part of a multiple property listing)

**number of contributing resources previously listed in the National Register**

N/A

0

**6. Function or Use**

**Historic Functions**  
(Enter categories from instructions)

**Current Functions**  
(Enter categories from instructions)

DOMESTIC/Single Dwellings

DOMESTIC/Secondary Structures

COMMERCE/TRADE/Specialty Stores

\_\_\_\_\_

\_\_\_\_\_

\_\_\_\_\_

\_\_\_\_\_

DOMESTIC/Single Dwellings

DOMESTIC/ Secondary Structures

COMMERCE/TRADE/Specialty Stores

COMMERCE/TRADE/Professional Offices

\_\_\_\_\_

\_\_\_\_\_

\_\_\_\_\_

\_\_\_\_\_

**7. Description**

**Architectural Classification**  
(Enter categories from instructions)

**Materials**  
(Enter categories from instructions)

Late 19<sup>th</sup> and 20<sup>th</sup> Century Revival/Cottage

Late 19<sup>th</sup> and 20<sup>th</sup> Century Revival/Tudor

Late 19<sup>th</sup> and 20<sup>th</sup> Century Revival/Colonial

Late 19<sup>th</sup> and 20<sup>th</sup> Century Revival/Bungalow

\_\_\_\_\_

\_\_\_\_\_

foundation Concrete/Brick/Stone

walls Brick/Stucco/Stone/Concrete/Cedar shingle

Aluminum/Vinyl

roof Slate, shingle, terra cotta, rubber

other Concrete/Brick/Stone

\_\_\_\_\_

\_\_\_\_\_

**Narrative Description**

(Describe the historic and current condition of the property on one or more continuation sheets)

8. Statement of Significance

Applicable National Register Criteria

(Mark "x" in one or more boxes for the criteria qualifying the property for National Register listing)

- A Property is associated with events that have made a significant contribution to the broad pattern of our history.
B Property associated with the lives of persons significant in our past.
C Property embodies the distinctive characteristics of a type, period, or method of construction or represents the work of a master, or possesses high artistic values, or represents a significant and distinguishable entity whose components lack individual distinction.
D Property has yielded, or is likely to yield, information important in prehistory or history.

Criteria Considerations

(Mark "x" in all the boxes that apply)

Property is:

- A owned by a religious institution or used for religious purposes.
B removed from its original location.
C a birthplace or grave.
D a cemetery.
E a reconstructed building, object, or structure.
F a commemorative property.
G less than 50 years of age or achieved significance within the past 50 years.

Area of Significance

(Enter categories from instructions)

ARCHITECTURE AND COMMUNITY PLANNING

Period of Significance

1922-1961

Significant Dates

1922

Significant Person

(Complete if Criterion B is marked above)

Cultural Affiliation

N/A

Architect/Builder

Multiple unknown

Narrative Statement of Significance

(Explain the significance of the property on one or more continuation sheets)

9. Major Bibliographical References

Bibliography

(Cite the books, articles, and other sources used in preparing this form on one or more continuation sheets)

Previous documentation on files (NPS):

- preliminary determination of individual listing (36 CFR 67) has been requested
previously listed in the National Register
previously determined eligible by the National Register
designated a National Historic Landmark
recorded by Historic American Buildings Survey
recorded by Historic American Engineering Record

Primary location of additional data:

- State Historic Preservation Office
Other State agency
Federal agency
Local government
University
Other

Name of repository:

Anneslie Historic District (BA-3200)  
Name of Property

Baltimore County, Maryland  
County and State

**10. Geographical Data**

Acreage of Property 119 acres Towson & Baltimore East, MD USGS quads

**UTM References**

(Place additional UTM references on a continuation sheet)

1	1	8	3	6	2	2	8	2	4	3	5	9	8	2	3
	Zone		Easting			Northing									
2	1	8	3	6	2	3	4	7	4	3	5	9	4	6	2

3	1	8	3	6	2	3	4	7	4	3	5	9	5	0	6
	Zone		Easting			Northing									
4	1	8	3	6	1	4	6	6	4	3	5	9	9	9	5

See continuation sheet

**Verbal Boundary Description**

(Describe the boundaries of the property on a continuation sheet)

**Boundary Justification**

(Explain why the boundaries were selected on a continuation sheet)

**11. Form Prepared By**

name/title Leah Burch; Mark Lewandowski, Nancy Hoffman  
Organization University of Maryland; Anneslie Community Association date October 2011  
street & number 730 Anneslie Road telephone \_\_\_\_\_  
city or town Baltimore state MD zip code 21212

**Additional Documentation**

Submit the following items with the completed form:

**Continuation Sheets**

**Maps**

A **USGS map** (7.5 or 15 minute series) indicating the property's location.

A **Sketch map** for historic districts and properties having large acreage or numerous resources.

**Photographs**

Representative **black and white photographs** of the property.

**Additional Items**

(Check with the SHPO or FPO for any additional items)

**Property Owner**

(Complete this item at the request of SHPO or FPO)

name \_\_\_\_\_  
street & number \_\_\_\_\_ telephone \_\_\_\_\_  
city or town \_\_\_\_\_ state \_\_\_\_\_ zip code \_\_\_\_\_

**Paperwork Reduction Statement:** This information is being collected for applications to the National Register of Historic Places to nominate properties for listing or determine eligibility for listing, to list properties, and to amend existing listings. Response to this request is required to obtain a benefit in accordance with the National Historic Preservation Act, as amended (16 U.S.C. 470 *et. seq.*).

**Estimated Burden Statement:** Public reporting burden for this form is estimated to average 18.1 hours per response including the time for reviewing instructions, gathering and maintaining data, and completing and reviewing the form. Direct comments regarding this burden estimate or any aspect of this form to the Chief, Administrative Services Division, National Park Service, P.O. Box 37127, Washington, DC 20013-7127; and the Office of Management and Budget, Paperwork Reductions Project (1024-0018), Washington, DC 20503.

United States Department of the Interior  
National Park Service

## National Register of Historic Places Continuation Sheet

BA-3200  
Anneslie Historic District

Name of Property

Baltimore County, MD

County and State

Section 7 Page 1

### Description Summary:

The Anneslie Historic District is a suburban subdivision located east of York Road in Baltimore County, Maryland, immediately north of the Baltimore City line. The neighborhood developed during the period 1922-1961, and comprises 477 contributing resources representing a broad variety of residential types that characterize that period, including bungalow, cottage, Foursquare, Tudor, Colonial, and Cape Cod styles. A small cluster of commercial buildings is located at the western edge of the district.

### General Description:

The Anneslie subdivision, platted in 1922, comprises fourteen blocks of uniform lots, created by a grid of five streets extending eastward from York Road, a major thoroughfare connecting Baltimore City with the Baltimore County seat of Towson. The street pattern is overlaid upon topography which is flat in the northern section, but increasingly rolling in the southern part. At the western edge of the neighborhood, a small complex of commercial buildings developed along the east side of York Road, providing amenities for the community.

Generally speaking, development of Anneslie began in the northern and western area and proceeded to the south and east. Regester Avenue, Murdock, Anneslie, and Dunkirk roads are lined with bungalows, cottages, and Foursquares from the 1920s and 30s; more southerly streets such as Overbrook and Windwood are characterized by Tudors, Colonials, and Cape Cods from the 1930s through the 1950s. Villa Anneslie, the ca. 1855 Italian Villa which originally commanded the 119-acre tract, remains on a three-acre parcel on the south side of Dunkirk Road. Houses are uniformly set back from the street. Many of the properties include garages, detached or – in the southern part of the district, where topography is more irregular – at basement level.

The district is characterized by a variety of popular building types and architectural styles representing the period 1922-1961.

Many of the earliest houses in the neighborhood are Bungalows, generally of frame construction on a parged or rusticated block foundation, 1-1/2 stories in height, with an integral porch and a large front-facing dormer. Many of these bungalows remain clad in wood shingles or stucco.

The cubical, hip-roofed Foursquare house form appears infrequently in the district; noteworthy examples include 6701 York Road, a large brick Foursquare with Colonial Revival detailing; 513 Murdock Road, executed in rusticated concrete block with cast-stone porch columns; and 523 Anneslie, a smaller stucco Foursquare.

United States Department of the Interior  
National Park Service

## National Register of Historic Places Continuation Sheet

BA-3200  
Anneslie Historic District

Name of Property

Baltimore County, MD

County and State

Section 7 Page 2

A number of eclectic Cottages are interspersed among the contemporaneous bungalows. Number 510 Dunkirk Road is a representative example, of frame construction, two stories in height with a broad front porch under an extension of its slate-clad gable roof, and a large shed dormer with two paired six-over-six sash across the façade. Number 519 is similar, and features slate sheathing its front dormer and an early porch enclosure with pebble-glass fanlights. Another example is 515 Anneslie Road, in stucco with a detached one-car garage.

Particularly noteworthy are several one-story stucco houses that reflect Mediterranean influence. Number 730 Anneslie Road is a flat-roofed, Spanish Mission style house with an attached garage framing a courtyard. A small house at 623 Anneslie Road was advertised by the builder as "A Home from Sunny Italy." A 1932 newspaper advertisement described 611 Anneslie Road as an "Insulated California Bungalow;" an arcaded porch spans its façade, and its low-pitched gable roof was originally clad in tile. Next door, 609 Anneslie Road remains much as it appeared in an illustration accompanying a 1932 advertisement, one story with a hipped roof and multiple projecting gables. Number 606 Anneslie Road is a one-story stucco cottage with a hipped roof that retains its original red tile. Adjacent on the east, 608 Anneslie Road is also a hip-roofed cottage, with arched window openings expressed in stucco detailing.

Several houses in Anneslie follow a model described by the builder as a "Colonial Bungalow," whose multiple front-facing gables actually seem more related to the Tudor style. A concentration of these houses occurs in the 700 block of Dunkirk Road. Number 726 was shown in a 1932 newspaper advertisement; across the street, number 725 presents a mirror image, and retains wood shingle siding and an open porch.

Tudor-style houses – typically of brick, often with stone detailing, and also frame and stucco – occur throughout the district. A particularly noteworthy concentration of 1930s Tudors is located on the north side of Anneslie Road in the 600 and 700 blocks. Similar Tudors are concentrated in the western blocks of Overbrook Road. These houses feature a steeply sloping roof, with a broad gable projection framing a round-arched doorway.

Several Colonial Revival houses of the 1920s and 30s occur in the northern part of the district. The southern part, especially along Overbrook and Windwood roads, comprises later Colonial-influenced houses, typically of brick, two stories in height, with center-hall or side-entrance plans.

The 1-1/2 story Cape Cod type occurs primarily in the southern part of the district, typically in brick. An early frame example is located at 709 Murdock Road, and a picturesque stone

United States Department of the Interior  
National Park Service

## National Register of Historic Places Continuation Sheet

BA-3200  
Anneslie Historic District

---

Name of Property

Baltimore County, MD

---

County and State

Section 7 Page 3

veneered Cape Cod appears at 707 Overbrook Road. Several mid-century Cape Cods employ Contemporary design elements in their deep roof overhangs and large picture windows; examples include 706 and 704 Overbrook Road, and 721 Anneslie Road. More conservative 1950s brick Cape Cods are found elsewhere in the 700 block of Overbrook, and along Windwood Road.

Along York Road, a cluster of commercial buildings serves the community. Early free-standing one-story brick commercial buildings include 6801 (1925), 6811 (1935), and 6729 (1940). Larger two-story commercial blocks were built in the Post-WWII period, including 6705-21 (1947) and 6803-05 (1950). Still later office buildings – and commercial conversions of residential structures – appear in the 6500 and 6600 blocks.

The Anneslie Historic District retains a high degree of integrity. The overwhelming majority of the properties comprising the district clearly express their original form and massing, and most retain their period exterior materials and detailing. Alterations within the district are generally limited to the application of synthetic siding and replacement of windows. Some houses have been expanded with additions to the rear; in only a few cases are these additions so substantial as to compromise the integrity of the properties.



United States Department of the Interior  
National Park Service

# National Register of Historic Places Continuation Sheet

BA-3200  
Anneslie Historic District

Name of Property

Baltimore County, MD

County and State

Section 8 Page 1

## Summary Statement of Significance:

The Anneslie Historic District is significant under Criterion A for its association with the early 20<sup>th</sup> century suburbanization of the York Road corridor north of the Baltimore City line. Beginning in the early 1920s and extending to mid-century, this area was the focus of considerable residential development thanks to its proximity to the city and easy access via streetcar and later automobile. Anneslie was one of three adjacent subdivisions that developed during this period. Offering detached houses of modest scale, Anneslie complemented its neighbors Stoneleigh to the north (1922; NR listed 2003), which offered somewhat larger houses and lot sizes, and Rodgers Forge to the west (1931; NR listed 2009), a community of brick rowhouses. It derives additional significance under Criterion C as a representative example of a type of early 20<sup>th</sup> century subdivision, characterized by uniform lots laid out in a gridiron plan. The neighborhood is primarily residential in character, and its properties reflect a variety of popular styles. Villa Anneslie, the Italianate mansion which was the centerpiece of the 119-acre tract prior to subdivision, remains in place among the later houses, a relatively rare surviving example of the rural retreats which characterized the York Road corridor in the latter half of the nineteenth century.

The Period of Significance begins in 1922 with the acquisition of the property by the Steffey Company and the creation of the subdivision plan, and ends in 1961, by which date the neighborhood was essentially fully developed.

## Resource History and Historic Context:

### HISTORICAL BACKGROUND

#### Baltimore County

Baltimore County was named for Cecilius Calvert, the second Lord Baltimore of Maryland. Its territory consisted at one time of parts of Baltimore City, Cecil and Harford Counties, as well as Carroll, Anne Arundel, Frederick, Howard, and Kent. Though the exact date of its establishment is unknown, it was officially documented as a county in 1659.<sup>1</sup> Baltimore Town, known now as Baltimore City, became the county seat in 1768, and eventually separated to form its own municipality in 1854.<sup>2</sup> Baltimore County today has a total area of 682 square miles and a population of 763,000. It is bounded to the north by the Pennsylvania border, to the south by Anne Arundel County, to the northeast by Harford, to the southwest by Howard, and to the northwest by Carroll. Baltimore County is the most centrally located of Maryland's counties. Its proximity to the city of Baltimore greatly affected the development of the county over time and the eventual suburbanization and migration from the city in the 19<sup>th</sup> and 20<sup>th</sup> centuries.

United States Department of the Interior  
National Park Service

## National Register of Historic Places Continuation Sheet

BA-3200  
Anneslie Historic District

Name of Property

Baltimore County, MD

County and State

Section 8 Page 2

As Baltimore County developed, the area between the city of Baltimore and the county seat at Towson became the site of country estates for prosperous Baltimoreans. York Road, an extension from Towson to Baltimore along which Anneslie sits, was laid out in 1799 as York Turnpike.<sup>3</sup> The short distance along York Road between the city and county meant that wealthy residents could live and work in Baltimore and vacation at their rural estates just outside. This trend continued into the early 20<sup>th</sup> century when developers began marketing county suburban neighborhoods, like Anneslie, as a way to live in the country with the benefits of rural life, and travel into the city to work.

### **Villa Anneslie**

The origins of Anneslie can be traced to Lord Baltimore and the Howard family, when a tract of wooded land was granted by Lord Baltimore to Govane Howard. The land grant was known as Drumq Hazel and a home was built by Howard in what is now the Anneslie area, though it burned sometime in the 18<sup>th</sup> century.<sup>4</sup> A Baltimore importer named Robert Brown purchased 230 acres of land in 1850 from Philip R. Howard to build his own estate, known as Stoneleigh Villa.<sup>5</sup> He subsequently sold 119-acres of that tract to his brother-in-law Frederick Harrison.

Harrison, a native of Connecticut, was a land surveyor and a government engineer who worked as an assistant to Dr. William Howard in Baltimore. He began building his estate off York Road, adjacent to Stoneleigh Villa, in 1855 as a country home for his family, and named the property Villa Anneslie.<sup>6</sup> There is some dispute among historians whether the name was an homage to his wife or his daughter, both named Anne.

Villa Anneslie and Stoneleigh Villa were designed by the architect John Rudolph Niernsee, of the architectural firm Niernsee and Nielson in Baltimore. Known for his romantic and Italianate designs, Niernsee was responsible for a number of well-known estates throughout the Baltimore area, including Clifton, Dumbarton, and possibly Wyman Villa in Baltimore City.<sup>7</sup> As stated in the National Register Nomination for Villa Anneslie, “though the house is not exceptionally elaborate, the architect closely followed A.J. Downing’s designs. Niernsee’s asymmetrical design with a central tower over the entrance and his floor plan can be readily found in Downing’s books”—specifically Design XXII, “Villa in the Italian Style,” in Downing’s The Architecture of Country Houses (1850).

The Stoneleigh Villa estate was purchased by the Stoneleigh Corporation in 1922 and subdivided and the house torn down in 1955. Villa Anneslie survives as it did in the mid-19<sup>th</sup> century. It is one of only three country estate houses which have endured the commercial and residential development along York Road, between Baltimore City and Towson.

(Although Villa Anneslie is architecturally significant in its own right, and represents a rare surviving example of a country estate in the area, it is not directly related to the themes which constitute the

United States Department of the Interior  
National Park Service

## National Register of Historic Places Continuation Sheet

BA-3200  
Anneslie Historic District

Name of Property

Baltimore County, MD

County and State

Section 8 Page 3

district's significance, and its construction predates the Period of Significance for the district. Villa Anneslie was individually listed in the National Register in 1977.)

### Suburbanization in the U.S.

Planned suburbs began to appear as early as the 1850's, in places like Llewellyn Park, New Jersey (1857) and Riverside, Illinois (1869). Similar to country estates, they offered a haven from overcrowding in the cities while providing many of the amenities that made urban life so appealing. The National Park Service defines a historic residential suburb as:

*A geographic area, usually located outside the central city, that was historically connected to the city by one or more modes of transportation; subdivided and developed primarily for residential use according to a plan; and possessing a significant concentration, linkage, and continuity of dwellings on small parcels of land, roads and streets, utilities, and community facilities.*

The estates of Stoneleigh and Anneslie were close enough to the city of Baltimore to allow for daily travel, but without the noise, congestion, and pollution that plagued metropolitan areas in the 19<sup>th</sup> and early 20<sup>th</sup> centuries.

The National Park Service Bulletin on historic residential suburbs identifies four major types of suburbs, defined largely by the mode of transportation available at the time. These include: railroad and horsecar suburbs, 1830-1890, streetcar suburbs, 1888-1928, early automobile suburbs, 1908-1945, and Post-WWII and early highway suburbs, 1945-1960. Anneslie can be defined as both a streetcar suburb and an early automobile suburb, as both played a role in its structure and development.

### Transportation Trends

Transportation trends in Baltimore County at the turn of the century greatly advanced travel and the opportunity to live in one place and work in another. In 1895, York Road became Route 8 in the electric streetcar line that ran from Towson to Catonsville. The line served York Road, Greenmount Avenue, and Frederick Road into the city.<sup>8</sup> The United Railways and Electric Company operated in the Baltimore metro area from 1899 to 1935. It was eventually replaced by the Baltimore Transit Company.

Streetcars offered inexpensive transportation that encouraged low- and middle- income families to relocate out of cities. Streetcar suburbs formed continuous corridors along route lines.<sup>9</sup>

By 1930, the automobile had become a competitor to the streetcar. In *United Railways v. Public Service Commission of Maryland* (1930), the railway applied to raise fares for transit service arguing that the use of street cars had declined since the introduction of the automobile, and the company did not have enough business to compensate its expenses.<sup>10</sup>

United States Department of the Interior  
National Park Service

## National Register of Historic Places Continuation Sheet

BA-3200  
Anneslie Historic District

Name of Property

Baltimore County, MD

County and State

Section 8 Page 4

Charles Steffey may have anticipated the eventual use of automobiles in Anneslie for both work and leisure; Sanborn Maps from June 1929 show that about one of every two residences had a detached garage.

In the United States, automobile registration between 1910 and 1930 increased from 458,000 to 22 million.<sup>11</sup> The mass production of cars all but eliminated the need for such services as the electric streetcar and suburban developments began to reflect the change in transportation trends towards cars. Attached and unattached garages became more common place, businesses and factories were able to move outside the city, and materials like asphalt (introduced in 1890s) became the common surface for roads by the 1920s.<sup>12</sup>

### ANNESLIE

Anneslie was the conception of real estate developer Charles H. Steffey. Undoubtedly influenced by the efforts of Edward Bouton and the construction of neighborhoods like Roland Park and Guilford, Steffey was a part of an emerging group of professionals known as "community builders." According to the National Park Service, "The term 'community builder' came into use in the first decade of the twentieth century in connection with the city planning movement and the development of large planned residential neighborhoods."

These neighborhoods were designed through the collaborative efforts of developers, site planners, engineers, architects, and landscape architects. The streets, lots, and public spaces were carefully selected, platted, and designed to reflect a particular aesthetic or to attract a certain type of homeowner. Deed restrictions and neighborhood covenants were then implemented to ensure that the developer would maintain control of their design even as the properties were sold.<sup>13</sup>

### Survey

In 1922, Steffey purchased all but three acres of the Villa Anneslie estate from Lennox Birckhead. Birckhead acquired the property from his father, also named Lennox Birckhead, who had married the daughter of Frederick Harrison.<sup>14</sup> The mansion remained in the Birckhead family until 1972. Lennox was an active member of the Anneslie Community Association, a neighborhood cooperative formed in 1926 which later became the non-profit group Anneslie Community, Inc. in 1944.<sup>15</sup>

Charles Steffey and the Steffey Corporation created neighborhoods like Ten Hills in Baltimore County (1910) and Admiral Heights in Annapolis (1937). A plat of Anneslie, surveyed by F.D. Dollenberg, was filed with the Baltimore County Land Records Office on May 25, 1922. The survey shows Anneslie consisting of 1,069 lots, 23 blocks, a setback for each lot of 25 feet, and an average lot size of 125 x 50

United States Department of the Interior  
National Park Service

## National Register of Historic Places Continuation Sheet

BA-3200  
Anneslie Historic District

Name of Property

Baltimore County, MD

County and State

Section 8 Page 5

feet. The plan is laid as a grid over rolling topography. This differed from the landscape design of nearby Stoneleigh, which responded to the natural slopes and curves of the topography.

Though Villa Anneslie and the three acres it sits on were not purchased by Steffey, and still exists today in its same location, the estate is not included in the 1922 plat. This suggests that perhaps there were plans at one time to purchase the remaining three acres and subdivide the property, as occurred with Stoneleigh Villa in 1955.

Ten Hills, like Anneslie, was once part of a country estate in Baltimore County. Charles Steffey hired civil engineers Augustus Bouldin and Co. to design and develop the landscape and street plan, with the intention of creating a natural and picturesque streetscape.<sup>16</sup> Whereas in Anneslie the plan was laid very simply as a grid overtop the rolling terrain, with no awareness of the landscape, the market in Ten Hills (as in Stoneleigh) was for a higher income homeowner and buyers would have appealed for a more picturesque, romantic design.

### Development

Steffey apparently constructed at least a limited number of houses on speculation, unlike similar subdivisions where lots were sold without improvements.<sup>17</sup> Most of the homes in Anneslie vary little in size and style; buyers chose designs within the framework of the architectural styles already selected and those pre-determined by design covenants for the neighborhood. Similarly in Ten Hills, deed covenant design guidelines were used by owners and their architects or builders to choose the type of home they wanted. The early architecture in Ten Hills consists mostly of Georgian, Tudor and Foursquare homes on ½ acre lots.<sup>18</sup>

Covenants and restrictions in Anneslie were used to control the aesthetic of the neighborhood as well as to prevent certain uses and exclude certain residents. In a deed dated October 10, 1925 from Charles H. Steffey, Inc. to John L. Hogarth and Mary A. Hogarth, for the transfer of lots 23 and 24 Block "N", the following restrictions were included,

*To wit no building shall be erected on said lots nearer than twenty five feet to the front line of said lots [...] No house shall be erected on said lots which shall cost less than thirty five hundred dollars [...] No house to be erected on any lot of less than fifty feet front [...] This property shall never be rented or sold to or for the use of persons of the negro race [...] No intoxicating liquors shall ever be manufactured or sold on said premises [...]*

Covenants like these were a way for developers to ensure that the character of the neighborhood and clientele for whom the neighborhood was intended would be maintained as lots were sold and properties transferred to new owners.

United States Department of the Interior  
National Park Service

## National Register of Historic Places Continuation Sheet

BA-3200  
Anneslie Historic District

Name of Property

Baltimore County, MD

County and State

Section 8 Page 6

### Marketing and Finance

All modern amenities like gas, water, electricity, telephone, telegraph, and sewer were included with the lots from the beginning. By 1923, the lots were fully equipped with the most up-to-date public services and buyers were guaranteed a home with working utilities upon purchase.<sup>19</sup>

A marketing advertisement for Anneslie published by Charles Steffey, Inc. around 1929 describes the benefits of living in this new neighborhood:

*Anneslie was opened in June 1922, and there are now over 160 homes there. They have water, gas, electricity, sewage, sidewalks, fire plugs, street lights, all macadam or concrete roads with be laid, and - best of all- there are county taxes. It has been restricted to cottage type homes, with no house built on a lot less than 50 feet front. This protects your investment against the crowding in of row houses and assures you that the beauty of the property will be maintained, a suburban development with open lawns, flowers and trees....In short, you find here a country home with every city advantage.*

The Steffey Corporation marketed Anneslie by running advertisements in newspapers, like the Baltimore Sun, distributing brochures, and holding open houses. Advertisements were geared towards families looking for an affordable and attractive place to live. "Young couples, just starting out; families with children who want to get ahead; thrifty folk who want to get most out of living and will not squander their money."<sup>20</sup>

Home ownership at this time in the United States became a priority for many families who could only afford to rent, and Anneslie was painted as a first class neighborhood accessible to nearly everyone. It held the best of both worlds- exclusivity without the costs of being exclusive. To ensure the affordability of homes, Steffey encouraged mortgages to help homebuyers finance the purchase of their property.

For a stucco bungalow located on Anneslie Road, listed at \$5,775, Steffey advertised that the property could be purchased for just a \$500 cash payment. To accomplish this, the homebuyer must obtain a Building and Loan Association mortgage of \$4,056 and a second mortgage of \$1,219. Weekly payments could be as low as \$17.92.<sup>21</sup>

Advertisements also stressed the proximity of Anneslie to local schools, the Towson business district, churches, parks, and the Hillendale and Rodgers Forge Golf Clubs.<sup>22</sup> In an interview conducted with current resident Jim Dobson, former President of the Anneslie Community Association, many of the same reasons were given for why homebuyers still find Anneslie such a desirable neighborhood. He noted the great school system, proximity to the city of Baltimore, and the number of activities available

United States Department of the Interior  
National Park Service

# National Register of Historic Places Continuation Sheet

BA-3200  
Anneslie Historic District

Name of Property

Baltimore County, MD

County and State

Section 8 Page 7

to residents; activities that today include: Anneslie Community Association, Boy Scouts, a community website and newsletter, holiday decorating contest, neighborhood block parties and annual picnics, and a citizen patrol.

## ENDNOTES

- <sup>1</sup> "Baltimore's History, Baltimore County, Maryland", <http://pages.baltimorecountymd.com/history.htm>, accessed December 16, 2007.
- <sup>2</sup> Ed. Edwin K. Gontrum, *Sidelights on the History of Baltimore County*, Towson, MD: 1966. 3-4
- <sup>3</sup> Ed. Edwin K. Gontrum, *Sidelights on the History of Baltimore County*, Towson, MD: 1966. 6
- <sup>4</sup> Jessop, Jennie, E. and Thomas R. Douglas, *The Origins of Names in Baltimore County*, Publications Committee, Baltimore County Historical Society: 1974. 6
- <sup>5</sup> Stoneleigh Historic District National Register nomination.
- <sup>6</sup> Andreve, George. "National Register of Historic Places Nomination Form for Villa Anneslie", 1977.
- <sup>7</sup> Chalfant, Randolph and Charles Belfoure, *Niernsee and Nielson, Architects of Baltimore*, Baltimore Architecture Foundation, Baltimore: 2006. 34, 36-37
- <sup>8</sup> Scharf, Thomas, *J. History of Baltimore City and County, Part II*, Regional Publishing Company, Baltimore, MD: 1971. 890-891.
- <sup>9</sup> Ames, David, L. and Linda Flint, "National Register Bulletin for Historic Residential Suburbs", National Park Service, 2002.
- <sup>10</sup> *United Railways v. Public Service Commission of Maryland*, 1930. <http://supreme.justia.com/us/280/234/case.html>, accessed September 30, 2007.
- <sup>11</sup> Ames, David, L. and Linda Flint, "National Register Bulletin for Historic Residential Suburbs", National Park Service, 2002.
- <sup>12</sup> Ames, David, L. and Linda Flint, "National Register Bulletin for Historic Residential Suburbs", National Park Service, 2002.
- <sup>13</sup> Diehlmann, Nicole, *Community Builders in Baltimore County*, Loyola College, 1994. 14-15
- <sup>14</sup> Andreve, George. "National Register of Historic Places Nomination Form for Villa Anneslie", 1977.
- <sup>15</sup> Diehlmann, Nicole, *Community Builders in Baltimore County*, Loyola College, 1994. 42
- <sup>16</sup> Commission for Historical and Architectural Preservation, "Ten Hills".  
<http://www.baltimorecity.gov/government/historic/districts/tenhills.php>, accessed November 15, 2007.
- <sup>17</sup> Diehlmann, Nicole, *Community Builders in Baltimore County*, Loyola College, 1994.
- <sup>18</sup> Commission for Historical and Architectural Preservation, "Ten Hills".  
<http://www.baltimorecity.gov/government/historic/districts/tenhills.php>, accessed November 15, 2007.
- <sup>19</sup> Steffey Corporation, "You can afford to live in Anneslie", 1929.
- <sup>20</sup> Steffey Corporation, "You can afford to live in Anneslie", 1929.
- <sup>21</sup> Steffey Corporation, "You can afford to live in Anneslie", 1929.
- <sup>22</sup> Steffey Corporation, "You can afford to live in Anneslie", 1929.

United States Department of the Interior  
National Park Service

# National Register of Historic Places Continuation Sheet

BA-3200  
Anneslie Historic District

Name of Property

Baltimore County, Maryland

County and State

Section 9 Page 1

## Major Bibliographical References:

- Ames, David L. and Linda Flint McClelland, "National Register Bulletin for Historic Residential Suburbs", National Park Service, 2002.
- Andreve, George. "Villa Anneslie," National Register of Historic Places Nomination Form, 1977.
- Baltimore County Land Records Office, Grantor Index to Deeds and Mortgages, Baltimore County, MD.
- Baltimore County Land Records Office, Plat Book WPC 7-40.
- Baltimore County Land Records Office, Plat Book WPC 7-87.
- "Baltimore's History, Baltimore County, Maryland," <http://pages.baltimorecountymd.com/history.htm>, accessed December 16, 2007.
- Brooks, Neal and Richard Parsons, *Baltimore County Panorama*, Baltimore County Public Library, Towson, MD: 1988.
- Chalfant, Randolph and Charles Belfoure, *Niernsee and Nielson, Architects of Baltimore*, Baltimore Architecture Foundation, Baltimore: 2006. 34, 36-37
- Baltimore City Commission for Historical and Architectural Preservation, "Ten Hills," <http://www.baltimorecity.gov/government/historic/districts/tenhills.php>, accessed November 15, 2007.
- Diehlmann, Nicole, *Community Builders in Baltimore County*, Loyola College, 1994.
- Downing, A. J. *The Architecture of Country Houses*. New York, 1850; rpt. New York: Dover Publications Inc., 1969.
- Ed. Edwin K. Gontrum, *Sidelights on the History of Baltimore County*, Towson, MD: 1966.
- Hahn, H. George and Carl Behm III, *Towson- A Pictorial History of a Maryland Town*. Donning Co., Norfolk, VA: 1977.
- Jessop, Jennie, E. and Thomas R. Douglas, *The Origins of Names in Baltimore County*, Publications Committee, Baltimore County Historical Society: 1974.
- Offutt, E. Frances, *Baltimore County Landmarks*, Baltimore County Public Library, Towson, MD: 1971.
- Scharf, J. Thomas. *History of Baltimore City and County, Part II*, Regional Publishing Company, Baltimore, MD: 1971.
- Steffey Corporation, "You can afford to live in Anneslie", 1929.
- Tracerries, Inc. "Stoneleigh Historic District," National Register of Historic Places Nomination Form.
- United Railways v. Public Service Commission of Maryland*, 1930. <http://supreme.justia.com/us/280/234/case.html>, accessed September 30, 2007.



United States Department of the Interior  
National Park Service

# National Register of Historic Places Continuation Sheet

BA-3200  
Anneslie Historic District

---

Name of Property

Baltimore County, MD

---

County and State

Section 10 Page 1

## Verbal Boundary Description:

The Anneslie Historic District is bounded on the west by York Road, where the Rodgers Forge NR Historic District abuts it. The northern boundary is marked by Regester Avenue, with the even-numbered (north) side of the street belonging to the NR-listed Stoneleigh neighborhood and the odd-numbered houses on the south side being part of Anneslie. The eastern boundary generally follows Maplewood Road and Windwood Road marks the southern boundary.

## Boundary Justification:

The boundaries of the Anneslie Historic District correspond to the original plat for the subdivision, dated 05/25/1922 and filed among the Land Records of Baltimore County in Plat Book WPC 7, p. 40.

United States Department of the Interior  
National Park Service

# National Register of Historic Places Continuation Sheet

BA-3200  
Anneslie Historic District  
Name of Property

Baltimore County, MD  
County and State

Section INVENTORY Page 1

Property Address	Year Built	Style	# of Stories	Ext. Constr.	Roofing	Garage Type	Notes
500 ANNESLIE RD	1926	Colonial	2.5	Asbestos Shingle	Slate	Detached	C
501 ANNESLIE RD	1938	Tudor	2	Brick	Slate	Attached	C
502 ANNESLIE RD	1925	Bungalow	1.5	ash	Slate	Detached	C
503 ANNESLIE RD	1938	Tudor	2	Brick	Slate	Attached	C
504 ANNESLIE RD	1927	Colonial	2.5	Asbestos Shingle	Slate	Detached	C
505 ANNESLIE RD	1929	Bungalow	1.5	siding	Shingle - Composite	Detached	C
506 ANNESLIE RD	1925	Bungalow	1.5	Stucco	Shingle - Composite		C
507 ANNESLIE RD	1924	Cottage	2	Siding	Slate	2 Car Detached	C
508 ANNESLIE RD	1925	Foursquare	2.5	Asbestos Shingle	Shingle - Composite	Detached	C
509 ANNESLIE RD	1938	Cape Cod	1.5	Brick	Shingle - Composite		C
510 ANNESLIE RD	1925	Bungalow	1.5	Vinyl	Shingle - Composite	Detached	C
511 ANNESLIE RD	1925	Bungalow	1.5	Siding	Shingle - Composite	Detached	C
512 ANNESLIE RD	1927	Bungalow	1.5	Shingle	Shingle - Composite	Carport	C
513 ANNESLIE RD	1925	Bungalow	1.5	Siding	Shingle - Composite		C
514 ANNESLIE RD	1927	Bungalow	1.5	Asbestos Shingle	Slate		C

United States Department of the Interior  
National Park Service

# National Register of Historic Places Continuation Sheet

BA-3200  
Anneslie Historic District

Name of Property

Baltimore County, MD

County and State

Section INVENTORY Page 2

Property Address	Year Built	Style	# of Stories	Ext. Constr.	Roofing	Garage Type	Notes
515 ANNESLIE RD	1925	Cottage	2	Stucco	Shingle - Composite	Detached	C
516 ANNESLIE RD	1927	Bungalow	1.5	Cedar Shingle	Slate	Detached	C
517 ANNESLIE RD	1925	Bungalow	1.5	Siding	Shingle - Composite	Detached	C
518 ANNESLIE RD	1950	Colonial	2	Asbestos Shingle		Detached	C
519 ANNESLIE RD	1925	Bungalow	1.5	Cedar	Slate		C
520 ANNESLIE RD	1926	Bungalow	1.5	Cedar Shingle Frame	Shingle - Composite	Detached	C
521 ANNESLIE RD	1925	Bungalow	1.5	Siding	Shingle - Composite	Detached	C
522 ANNESLIE RD	1973	Colonial	2	Vinyl	Shingle - Composite		NC
523 ANNESLIE RD	1932	Foursquare	2	Stucco	Slate		C
524 ANNESLIE RD	1972	Colonial	2	Brick/siding	Shingle - Composite		NC
525 ANNESLIE RD	1925	Bungalow	1.5	Siding	Shingle - Composite	Detached	C
526 ANNESLIE RD	1972	Colonial	2	Vinyl	Shingle - Composite		NC
527 ANNESLIE RD	1929/2005	Bungalow	2	Frame	Shingle - Composite	Attached	Substantially expanded NC
528 ANNESLIE RD	1972	Colonial	2	Vinyl	Shingle - Composite		NC
529 ANNESLIE RD	1949	Cape Cod	2	Brick	Shingle - Composite	Detached	C

United States Department of the Interior  
National Park Service

# National Register of Historic Places Continuation Sheet

BA-3200  
Anneslie Historic District

Name of Property

Baltimore County, MD

County and State

Section INVENTORY Page 3

Property Address	Year Built	Style	# of Stories	Ext. Constr.	Roofing	Garage Type	Notes
530 ANNESLIE RD	1972	Colonial	2	Brick/siding	Shingle - Composite		NC
531 ANNESLIE RD	1972	Colonial	2	Brick/Siding	Shingle - Composite		NC
532 ANNESLIE RD	1972	Colonial	2	Brick/siding	Shingle - Composite		NC
533 ANNESLIE RD	1933	Cottage	1.5	Brick	Slate	Undergnd/Bsmnt	C
534 ANNESLIE RD	1972	Colonial	2	Vinyl	Shingle - Composite		NC
536 ANNESLIE RD	1972	Colonial	2	Brick/siding	Shingle - Composite		NC
538 ANNESLIE RD	1972	Colonial	2	Brick/siding	Shingle - Composite		NC
540 ANNESLIE RD	1972	Colonial	2	Brick/siding	Shingle - Composite	none	NC
600 ANNESLIE RD	1927	Cottage	1.5	Stucco	Shingle	Detached	C
601 ANNESLIE RD	1929	Colonial	2.5	Brick	Shingle - Composite	Detached	C
602 ANNESLIE RD	1927	Cottage	1	Stucco	Shingle	none	C
603 ANNESLIE RD	1925	Bungalow	1.5	Brick	Slate	Detached	C
604 ANNESLIE RD	1926	Cottage	1	Stucco	Slate	Detached	C
605 ANNESLIE RD	1949	Cape Cod	2	Brick	Shingle - Composite		C
606 ANNESLIE RD	1927	Spanish	1	Stucco	Tile	Detached	C

United States Department of the Interior  
National Park Service

# National Register of Historic Places Continuation Sheet

BA-3200  
Anneslie Historic District

Name of Property

Baltimore County, MD

County and State

Section INVENTORY Page 4

Property Address	Year Built	Style	# of Stories	Ext. Constr.	Roofing	Garage Type	Notes
607 ANNESLIE RD	1941	Spanish	2	Brick	Shingle - Composite		C
608 ANNESLIE RD	1924	Spanish	1	Stucco	Shingle	none	C
609 ANNESLIE RD	1938	Spanish	1	Stucco	Tile	Undergnd/Bsmnt	Featured in 1932 newspaper ad C
610 ANNESLIE RD	1929	Bungalow	1.5	Vinyl	Shingle	Detached	C
611 ANNESLIE RD	1939	Spanish	1	Stucco	Shingle - Composite	Undergnd/Bsmnt	"California Bungalow" Featured in 1932 newspaper ad C
612 ANNESLIE RD	1951	Colonial	2	Brick/siding	Shingle	Attached	C
613 ANNESLIE RD	1937	Tudor	1.5	Brick	Shingle - Composite	Undergnd/Bsmnt	C
614 ANNESLIE RD	1957	Colonial	2	Brick/siding	Shingle - Composite	None	C
615 ANNESLIE RD	1937	Tudor	2	Brick	Slate	Undergnd/Bsmnt	C
616 ANNESLIE RD	1925	Bungalow	2	Vinyl	Shingle	Detached	C
617 ANNESLIE RD	1933	Tudor	2	Brick	Slate	Undergnd/Bsmnt	C
618 ANNESLIE RD	1925	Bungalow	1.5	Wood	Cedar/wood shingle	Detached	C
619 ANNESLIE RD	1933	Tudor	2	Brick	Slate	Undergnd/Bsmnt	Featured in 1932 newspaper ad C
620 ANNESLIE RD	1929	Bungalow	1.5	Asbestos Shingle	Shingle	Detached	C
621 ANNESLIE RD	1931	Tudor	1.5	Brick	Slate		C

United States Department of the Interior  
National Park Service

# National Register of Historic Places Continuation Sheet

BA-3200  
Anneslie Historic District

Name of Property

Baltimore County, MD

County and State

Section INVENTORY Page 5

Property Address	Year Built	Style	# of Stories	Ext. Constr.	Roofing	Garage Type	Notes
622 ANNESLIE RD	1929	Dutch Colonial	2	Stucco	Slate	none	C
623 ANNESLIE RD	1929	Cottage	1	stucco	Shingle - Composite	Detached	C
624 ANNESLIE RD	1935	Bungalow	2	Stucco/Brick	Shingle - Composite	Detached	C
625 ANNESLIE RD	1958	Colonial	2	Brick/Siding	Shingle - Composite		C
626 ANNESLIE RD	1953	Tudor	1.5	Brick	Shingle	Undergnd/Bsmnt	C
627 ANNESLIE RD	1930	Bungalow	2	Siding	Shingle - Composite	Detached	C
628 ANNESLIE RD	1933	Tudor	1.5	Brick	Slate	Attached	C
629 ANNESLIE RD	1959	Colonial	2	Brick	Shingle - Composite		C
631 ANNESLIE RD	1925	Bungalow	1.5	Asbestos Shingle	Shingle - Composite	Detached	C
633 ANNESLIE RD	1926	Bungalow	1.5	Asbestos Shingle	Shingle - Composite	Detached	C
635 ANNESLIE RD	1930	Foursquare	2	Asbestos Shingle	Shingle - Composite		C
637 ANNESLIE RD	1931	Cottage	1.5	Siding	Shingle - Composite		C
639 ANNESLIE RD	1933	Tudor	2	Brick	Slate	Undergnd/Bsmnt	C
700 ANNESLIE RD	1933	Colonial	2	Vinyl	Slate	Detached	C
701 ANNESLIE RD	1933	Tudor	1.5	Stucco	Shingle - Composite	Detached	C

United States Department of the Interior  
National Park Service

# National Register of Historic Places Continuation Sheet

BA-3200  
Anneslie Historic District

Name of Property

Baltimore County, MD

County and State

Section INVENTORY Page 6

Property Address	Year Built	Style	# of Stories	Ext. Constr.	Roofing	Garage Type	Notes
702 ANNESLIE RD	1933	Bungalow	1.5	Brick/siding	Shingle - Composite	Detached	C
703 ANNESLIE RD	1933	Tudor	1.5	Siding	Shingle - Composite		C
704 ANNESLIE RD	1926	Foursquare	2	Cedar	Shingle	none	C
705 ANNESLIE RD	1933	Tudor	1.5	Siding	Shingle - Composite		C
706 ANNESLIE RD	1933	Bungalow	1.5	Vinyl	Shingle	none	C
707 ANNESLIE RD	1935	Tudor	1.5	Brick	Shingle - Composite	Attached	C
708 ANNESLIE RD	1933	Colonial	2	Frame	Slate	Detached	C
709 ANNESLIE RD	1940	Cape Cod	2	Brick	Shingle - Composite	Attached	C
710 ANNESLIE RD	1933	Tudor	1.5	Brick	Shingle	Undergnd/Bsmnt	C
711 ANNESLIE RD	1933	Tudor	1.5	Brick	Slate	Attached	C
712 ANNESLIE RD	1933	Tudor	1.5	Brick	Shingle - Composite	Undergnd/Bsmnt	C
713 ANNESLIE RD	1933	Colonial	2	Brick	Slate	Undergnd/Bsmnt	C
714 ANNESLIE RD	1933	Cottage	1.5	Brick	Shingle	Undergnd/Bsmnt	C
715 ANNESLIE RD	1936	Tudor	1.5	Brick	Slate	Attached	C
716 ANNESLIE RD	1933	Tudor	1.5	Brick	Shingle	Undergnd/Bsmnt	C

United States Department of the Interior  
National Park Service

# National Register of Historic Places Continuation Sheet

BA-3200  
Anneslie Historic District  
Name of Property

Baltimore County, MD  
County and State

Section INVENTORY Page 7

Property Address	Year Built	Style	# of Stories	Ext. Constr.	Roofing	Garage Type	Notes
717 ANNESLIE RD	1939	Colonial	2	Brick	Slate	Undergnd/Bsmnt	C
718 ANNESLIE RD	1938	Tudor	1.5	Brick	Shingle - Composite	Undergnd/Bsmnt	C
719 ANNESLIE RD	1939	Tudor	2	Brick	Slate	Attached	C
720 ANNESLIE RD	1938	Tudor	1.5	Brick	Shingle	Undergnd/Bsmnt	C
721 ANNESLIE RD	1955	Contemporary Cape Cod	1.5	Brick			C
722 ANNESLIE RD	1947	Tudor	2	Brick	Slate	Undergnd/Bsmnt	C
723 ANNESLIE RD	1950	Cape Cod	1.5	Brick	Shingle - Composite		C
724 ANNESLIE RD	1938	Tudor	1.5	Brick	Shingle - Composite	Undergnd/Bsmnt	Featured In 1932 newspaper ad C
725 ANNESLIE RD	1954	Cape Cod	1.5	Siding	Shingle - Composite	Undergnd/Bsmnt	C
726 ANNESLIE RD	1938	Tudor	1.5	Brick	Shingle	Undergnd/Bsmnt	C
727 ANNESLIE RD	1953	Cape Cod	1.5	Siding	Shingle - Composite	Undergnd/Bsmnt	C
728 ANNESLIE RD	1938	Tudor	1.5	Brick	Shingle	none	C
729 ANNESLIE RD	1950	Cape Cod	1.5	Siding	Shingle - Composite		C
730 ANNESLIE RD	1937	Spanish Mission	1	Stucco	Tile/Rubber	Detached	C
731 ANNESLIE RD	1943	Cape Cod	2	Brick	Slate	Undergnd/Bsmnt	C



United States Department of the Interior  
National Park Service

# National Register of Historic Places Continuation Sheet

BA-3200  
Anneslie Historic District  
Name of Property

Baltimore County, MD  
County and State

Section INVENTORY Page 8

Property Address	Year Built	Style	# of Stories	Ext. Constr.	Roofing	Garage Type	Notes
733 ANNESLIE RD	1950	Cape Cod	1.5	siding	Shingle - Composite		C
500 DUNKIRK RD	1928	Bungalow	1.5	Frame	Wood Shingle	Detached	C
501 DUNKIRK RD	1937	Colonial	2	Brick	Slate	Detached	C
502 DUNKIRK RD	1927	Foursquare	2	Asbestos Shingle	Shingle - Composite	Detached	C
503 DUNKIRK RD	1936	Cottage	2	Brick	Slate	Detached	C
504 DUNKIRK RD	1925	Cottage	2	Asbestos Shingle	Shingle - Composite	Detached	C
505 DUNKIRK RD	1939	Tudor	1.5	Frame	Shingle - Composite	Detached	C
506 DUNKIRK RD	1923	Foursquare	2	Asbestos Shingle	Slate		C
507 DUNKIRK RD	1924	Bungalow	1.5	Asbestos Shingle	Shingle - Composite		C
508 DUNKIRK RD	1940	Colonial	2.5	Brick	Slate	Attached	C
509 DUNKIRK RD	1931	Tudor	1.5	Brick		Undergnd/Bsmnt	C
510 DUNKIRK RD	1928	Bungalow	2	Asbestos Shingle	Slate	Detached	C
511 DUNKIRK RD	1930	Bungalow	1.5	Asbestos Shingle	Shingle - Composite	Detached	C
512 DUNKIRK RD	1929	Bungalow	2	Frame	Shingle - Composite	Detached	C
513 DUNKIRK RD	1929	Bungalow	1.5	Frame	Shingle - Composite	Detached	C

United States Department of the Interior  
National Park Service

# National Register of Historic Places Continuation Sheet

BA-3200  
Anneslie Historic District

Name of Property

Baltimore County, MD

County and State

Section INVENTORY Page 9

Property Address	Year Built	Style	# of Stories	Ext. Constr.	Roofing	Garage Type	Notes
514 DUNKIRK RD	1943	Cape Cod	1.5	Brick	Slate	Detached	C
515 DUNKIRK RD	1927	Cottage	2	Vinyl	Shingle - Composite		C
516 DUNKIRK RD	1921	Foursquare	2	Asbestos Shingle	Slate	Detached	C
517 DUNKIRK RD	1925	Cottage	1.5	Stucco	Shingle - Composite	Detached	C
518 DUNKIRK RD	1950	Cape Cod	1.5	Vinyl	Shingle - Composite		C
519 DUNKIRK RD	1937	Colonial	2	Asbestos Shingle	Shingle - Composite		C
520 DUNKIRK RD	1930	Cottage	1.5	Asbestos Shingle	Shingle - Composite		C
521 DUNKIRK RD	1927	Cottage	2.5	Sliding	Shingle - Composite		C
522 DUNKIRK RD	1929	Cottage	1.5	Asbestos Shingle	Shingle - Composite	Detached	C
523 DUNKIRK RD	1974	Colonial	2	Vinyl	Shingle - Composite		NC
524 DUNKIRK RD	1938	Colonial	2	Brick	Shingle - Composite	Detached	C
526 DUNKIRK RD	1932	Tudor	1.5	Brick	Shingle - Composite	Detached	C
528 DUNKIRK RD	1925	Colonial	2	Wood	Shingle - Composite	Detached	C
529 DUNKIRK RD	1855	Italian Villa	2	Frame	Slate		NC (individually listed in NR)
530 DUNKIRK RD	1942	Colonial	2	Stone/Frame	Slate	Built In	C

United States Department of the Interior  
National Park Service

# National Register of Historic Places Continuation Sheet

BA-3200  
Anneslie Historic District

Name of Property

Baltimore County, MD

County and State

Section INVENTORY Page 10

Property Address	Year Built	Style	# of Stories	Ext. Constr.	Roofing	Garage Type	Notes
535 DUNKIRK RD	1973	Colonial	2	Vinyl	Shingle - Composite		NC
537 DUNKIRK RD	1973	Colonial	2	Vinyl	Shingle - Composite		NC
539 DUNKIRK RD	1973	Colonial	2	Vinyl	Shingle - Composite		NC
541 DUNKIRK RD	1928	Colonial	2	Stucco	Shingle - Composite	Detached	C
600 DUNKIRK RD	1926	Foursquare	2	Wood	Shingle - Composite	Detached	C
601 DUNKIRK RD	1929	Colonial	2.5	Asbestos Shingle	Shingle - Composite	Detached	C
602 DUNKIRK RD	1951	Colonial	2	Asbestos Shingle	Shingle - Composite	Detached	C
603 DUNKIRK RD	1928	Foursquare	2	Wood	Shingle - Composite	Detached	C
604 DUNKIRK RD	1930	Cottage	1	Wood	Shingle - Composite	Detached	C
605 DUNKIRK RD	1930	Dutch Colonial	1.5	Frame	Shingle - Composite	Detached	C
606 DUNKIRK RD	1928	Bungalow	1.5	Asbestos Shingle	Shingle - Composite	Detached	C
607 DUNKIRK RD	1924	Foursquare	2	Wood	Shingle - Composite	Detached	C
608 DUNKIRK RD	1931	Bungalow	2	Frame	Shingle - Composite	Detached	C
610 DUNKIRK RD	1924	Bungalow	1.5	Vinyl	Shingle - Composite	Detached	C
611 DUNKIRK RD	1924	Bungalow	1.5	Asbestos Shingle	Shingle - Composite	Detached	C

United States Department of the Interior  
National Park Service

# National Register of Historic Places Continuation Sheet

BA-3200  
Anneslie Historic District

Name of Property

Baltimore County, MD

County and State

Section INVENTORY Page 11

Property Address	Year Built	Style	# of Stories	Ext. Constr.	Roofing	Garage Type	Notes
612 DUNKIRK RD	1924	Bungalow	1.5	Asbestos Shingle	Shingle - Composite	Detached	C
613 DUNKIRK RD	1924	Bungalow	1.5	Asbestos Shingle	Shingle - Composite	Detached	C
614 DUNKIRK RD	1952	Cape Cod	1.5	Asbestos Shingle	Shingle - Composite	Detached	C
615 DUNKIRK RD	1924	Bungalow	1.5	Asbestos Shingle	Shingle - Composite	Detached	C
616 DUNKIRK RD	1951	Cape Cod	1.5	Frame	Shingle - Composite	Detached	C
617 DUNKIRK RD	1924	Bungalow	1.5	Asbestos Shingle	Shingle - Composite	Detached	C
618 DUNKIRK RD	1925	Foursquare	2	Vinyl	Shingle - Composite	Detached	C
619 DUNKIRK RD	1924	Bungalow	1.5	Vinyl	Shingle - Composite	Detached	C
620 DUNKIRK RD	1926	Foursquare	2	Asbestos Shingle	Shingle - Composite		C
621 DUNKIRK RD	1939	Tudor	2	Brick	Shingle - Composite	Detached	C
622 DUNKIRK RD	1933	Cottage	1.5	Brick	Shingle - Composite		C
623 DUNKIRK RD	1924	Bungalow	1.5	Asbestos Shingle	Shingle - Composite	Detached	C
624 DUNKIRK RD	1926	Bungalow	1.5	Frame	Shingle - Composite	Undergnd/Bsmnt	C
625 DUNKIRK RD	1924	Bungalow	1.5	Asbestos Shingle	Shingle - Composite	Detached	C
626 DUNKIRK RD	1926	Bungalow	1.5	Frame	Shingle - Composite	Detached	C

United States Department of the Interior  
National Park Service

# National Register of Historic Places Continuation Sheet

BA-3200  
Anneslie Historic District  
Name of Property

Baltimore County, MD  
County and State

Section INVENTORY Page 12

Property Address	Year Built	Style	# of Stories	Ext. Constr.	Roofing	Garage Type	Notes
627 DUNKIRK RD	1930	Bungalow	1.5	Asbestos Shingle	Shingle - Composite	Detached	C
628 DUNKIRK RD	1926	Bungalow	1.5	Asbestos Shingle	Shingle - Composite		C
629 DUNKIRK RD	1950	Cottage	1.5	Brick	Shingle - Composite	Detached	C
630 DUNKIRK RD	1926	Bungalow	1.5	Vinyl	Shingle - Composite	Detached	C
632 DUNKIRK RD	1924	Bungalow	2	Vinyl	Shingle - Composite	Detached	C
634 DUNKIRK RD	1928	Bungalow	1.5	Vinyl	Shingle - Composite	Detached	C
636 DUNKIRK RD	1928	Bungalow	1.5	Vinyl	Shingle - Composite		C
638 DUNKIRK RD	1932	Tudor	1.5	Vinyl	Shingle - Composite		C
700 DUNKIRK RD	1924	Tudor	2	Vinyl	Shingle - Composite	Detached	C
701 DUNKIRK RD	1933	Tudor	2	Vinyl	Shingle - Composite	Detached	C
702 DUNKIRK RD	1928	Cottage	1.5	Vinyl	Shingle - Composite	Detached	C
703 DUNKIRK RD	1933	Bungalow	1.5	Vinyl	Shingle - Composite		C
704 DUNKIRK RD	1928	Dutch Colonial	1.5	Vinyl	Shingle - Composite	Detached	C
705 DUNKIRK RD	1933	Tudor	1.5	Vinyl	Shingle - Composite	Detached	C
706 DUNKIRK RD	1928	Bungalow	2	Frame	Shingle - Composite	Detached	C

United States Department of the Interior  
National Park Service

# National Register of Historic Places Continuation Sheet

BA-3200  
Anneslie Historic District

Name of Property

Baltimore County, MD

County and State

Section INVENTORY Page 13

Property Address	Year Built	Style	# of Stories	Ext. Constr.	Roofing	Garage Type	Notes
707 DUNKIRK RD	1933	Cottage	1.5	Wood	Shingle - Composite	Detached	C
708 DUNKIRK RD	1928	Cottage	1.5	Frame	Shingle - Composite	Detached	C
709 DUNKIRK RD	1931	Tudor	1.5	Vinyl	Shingle - Composite		C
710 DUNKIRK RD	1927	Cottage	1.5	Wood	Shingle - Composite		C
711 DUNKIRK RD	1931	Cottage	1.5	Vinyl	Shingle - Composite	Detached	C
712 DUNKIRK RD	1928	Tudor	1.5	Vinyl	Shingle - Composite		C
713 DUNKIRK RD	1933	Tudor	1.5	Vinyl	Shingle - Composite		C
714 DUNKIRK RD	1931	Tudor	1.5	Vinyl	Shingle - Composite	Detached	C
715 DUNKIRK RD	1933	Tudor	1.5	Vinyl	Shingle - Composite		C
716 DUNKIRK RD	1940	Colonial	2	Brick	Slate	Attached	C
717 DUNKIRK RD	1932	Tudor	1.5	Vinyl	Shingle		C
718 DUNKIRK RD	1941	Colonial	2	Brick	Slate	Attached	C
719 DUNKIRK RD	1932	Tudor	1.5	Vinyl	Shingle - Composite		C
720 DUNKIRK RD	1938	Colonial	2	Brick	Slate	Attached	C
721 DUNKIRK RD	1932	Tudor	1.5	Vinyl	Shingle - Composite	Detached	C

United States Department of the Interior  
National Park Service

# National Register of Historic Places Continuation Sheet

BA-3200  
Anneslie Historic District

Name of Property

Baltimore County, MD

County and State

Section INVENTORY Page 14

Property Address	Year Built	Style	# of Stories	Ext. Constr.	Roofing	Garage Type	Notes
722 DUNKIRK RD	1932	Tudor	1.5	Vinyl	Shingle - Composite		C
723 DUNKIRK RD	1933	Cottage	1.5	Wood	Shingle - Composite	Detached	C
724 DUNKIRK RD	1930	Bungalow	2	Vinyl	Shingle - Composite		C
725 DUNKIRK RD	1933	Tudor	2	Wood	Shingle - Composite		C
726 DUNKIRK RD	1933	Tudor	1.5	Frame	Shingle - Composite		"Colonial White Shingle Bungalow" Featured in 1932 newspaper ad C
727 DUNKIRK RD	1933	Cottage	1.5	Vinyl	Shingle - Composite	Detached	C
728 DUNKIRK RD	1955	Cape Cod	1.5	Vinyl	Shingle - Composite		C
729 DUNKIRK RD	1930	Tudor	1.5	Vinyl	Shingle - Composite		C
500 MURDOCK RD	1922	Cottage	2.5	Stucco	Slate	Detached	C
501 MURDOCK RD	1929	Cottage	1.5	Brick	Slate	Detached	C
502 MURDOCK RD	1925	Cottage	2.5	Asbestos Shingle	Shingle - Composite	Detached	C
503 MURDOCK RD	1952	Colonial	2	Asbestos Shingle	Shingle - Composite		C
504 MURDOCK RD	1932	Tudor	2	Asbestos Shingle	Shingle - Composite	Detached	C
505 MURDOCK RD	1925	Foursquare	2.5	Asbestos Shingle	Slate	Detached	C
506 MURDOCK RD	1924	Bungalow	1.5	Wood	Shingle - Composite		C

United States Department of the Interior  
National Park Service

# National Register of Historic Places Continuation Sheet

BA-3200  
Anneslie Historic District  
Name of Property

Baltimore County, MD  
County and State

Section INVENTORY Page 15

Property Address	Year Built	Style	# of Stories	Ext. Constr.	Roofing	Garage Type	Notes
507 MURDOCK RD	1925	Foursquare	2	Asbestos Shingle	Shingle - Composite	Detached	C
508 MURDOCK RD	1925	Bungalow	1.5	Vinyl	Shingle - Composite	Detached	C
509 MURDOCK RD	1927	Bungalow	1.5	Vinyl	Shingle - Composite		C
510 MURDOCK RD	1925	Bungalow	2	Vinyl	Shingle - Composite	Detached	C
511 MURDOCK RD	1928	Bungalow	2	Frame	Shingle - Composite		C
512 MURDOCK RD	1925	Foursquare	2.5	Vinyl	Shingle - Composite	Detached	C
513 MURDOCK RD	1929	Foursquare	2.5	Formstone	Shingle - Composite	Detached	C
514 MURDOCK RD	1952	Cape Cod	1.5	Brick	Shingle - Composite		C
515 MURDOCK RD	1929	Bungalow	1.5	Vinyl	Shingle - Composite		C
516 MURDOCK RD	1948	Colonial	2.5	Brick	Shingle - Composite	Detached	C
517 MURDOCK RD	1928	Foursquare	2	Wood	Shingle - Composite	Detached	C
518 MURDOCK RD	1928	Bungalow	2	Stucco	Shingle - Composite	Detached	C
519 MURDOCK RD	1928	Bungalow	1.5	Vinyl	Shingle - Composite	Detached	C
520 MURDOCK RD	1928	Cottage	1.5	Stucco	Shingle - Composite		C
521 MURDOCK RD	1925	Bungalow	1.5	Vinyl	Shingle - Composite		C



United States Department of the Interior  
National Park Service

# National Register of Historic Places Continuation Sheet

BA-3200  
Anneslie Historic District  
Name of Property

Baltimore County, MD  
County and State

Section INVENTORY Page 16

Property Address	Year Built	Style	# of Stories	Ext. Constr.	Roofing	Garage Type	Notes
522 MURDOCK RD	1924	Bungalow	1.5	Wood	Shingle - Composite	Detached	C
523 MURDOCK RD	1928	Bungalow	1.5	Formstone	Slate		C
524 MURDOCK RD	1925	Foursquare	2	Vinyl	Shingle - Composite	Detached	C
525 MURDOCK RD	1924	Bungalow	2	Vinyl	Shingle - Composite	Detached	C
526 MURDOCK RD	1949	Cape Cod	1.5	Brick	Shingle - Composite	Detached	C
527 MURDOCK RD	1927	Bungalow	2	Wood	Shingle - Composite		C
528 MURDOCK RD	1926	Bungalow	1.5	Vinyl	Shingle - Composite	Detached	C
529 MURDOCK RD	1927	Foursquare	2	Asbestos Shingle	Shingle - Composite	Carport	C
530 MURDOCK RD	1939	Cape Cod	1.5	Brick	Slate	Detached	C
531 MURDOCK RD	1937	Colonial	2	Brick	Slate	Detached	C
600 MURDOCK RD	1928	Bungalow	1.5	Vinyl	Shingle - Composite	Detached	C
601 MURDOCK RD	1932	Colonial	2	Asbestos Shingle	Shingle - Composite	Detached	C
602 MURDOCK RD	1924	Foursquare	2	Frame	Shingle - Composite	Detached	C
603 MURDOCK RD	1924	Cottage	2	Asbestos Shingle	Shingle - Composite	Detached	C
604 MURDOCK RD	1928	Cottage	2	Asbestos Shingle	Shingle - Composite		C

United States Department of the Interior  
National Park Service

# National Register of Historic Places Continuation Sheet

BA-3200  
Anneslie Historic District

Name of Property

Baltimore County, MD

County and State

Section INVENTORY Page 17

Property Address	Year Built	Style	# of Stories	Ext. Constr.	Roofing	Garage Type	Notes
605 MURDOCK RD	1930	Cottage	2	Vinyl	Shingle - Composite	Attached	C
606 MURDOCK RD	1931	Cottage	1.5	Vinyl	Shingle - Composite		C
607 MURDOCK RD	1930	Cottage	1.5	Wood	Shingle - Composite		C
608 MURDOCK RD	1925	Bungalow	1.5	Vinyl	Shingle - Composite	Detached	C
609 MURDOCK RD	1930	Bungalow	2	Vinyl	Shingle - Composite	Detached	C
610 MURDOCK RD	1928	Cottage	2	Asbestos Shingle	Shingle - Composite	Detached	C
611 MURDOCK RD	1930	Dutch Colonial	2.5	Vinyl	Shingle - Composite	Detached	C
612 MURDOCK RD	1927	Dutch Colonial	2	Stucco	Slate	Detached	C
613 MURDOCK RD	1924	Bungalow	1.5	Asbestos Shingle	Shingle - Composite	Detached	C
614 MURDOCK RD	1926	Cottage	2	Vinyl	Shingle - Composite	Detached	C
615 MURDOCK RD	1928	Bungalow	1.5	Stucco	Shingle - Composite		C
616 MURDOCK RD	1927	Bungalow	1.5	Asbestos Shingle	Shingle - Composite	Detached	C
617 MURDOCK RD	1930	Bungalow	2	Vinyl	Shingle - Composite		C
618 MURDOCK RD	1928	Bungalow	2	Stucco/Vinyl	Shingle - Composite		C
619 MURDOCK RD	1918	Bungalow	2	Frame	Shingle - Composite		C

United States Department of the Interior  
National Park Service

# National Register of Historic Places Continuation Sheet

BA-3200  
Anneslie Historic District  
Name of Property

Baltimore County, MD  
County and State

Section INVENTORY Page 18

Property Address	Year Built	Style	# of Stories	Ext. Constr.	Roofing	Garage Type	Notes
620 MURDOCK RD	1928	Cottage	2	Vinyl	Shingle - Composite		C
621 MURDOCK RD	1930	Bungalow	2	Vinyl	Shingle - Composite		C
622 MURDOCK RD	1950	Colonial	2	Stucco	Shingle - Composite		C
623 MURDOCK RD	1928	Bungalow	2	Wood	Shingle - Composite	Detached	C
624 MURDOCK RD	1925	Cottage	1.5	Vinyl	Shingle - Composite		C
625 MURDOCK RD	1928	Bungalow	1.5	Vinyl	Shingle - Composite		C
626 MURDOCK RD	1928	Bungalow	2	Vinyl	Shingle - Composite	Detached	C
627 MURDOCK RD	1928	Bungalow	1.5	Wood	Shingle - Composite	Detached	C
628 MURDOCK RD	1928	Bungalow	1.5	Frame	Shingle - Composite	Detached	C
629 MURDOCK RD	1928	Colonial	2.5	Vinyl	Shingle - Composite	Detached	C
630 MURDOCK RD	1928	Cottage	1.5	Asbestos Shingle	Shingle - Composite	Detached	C
631 MURDOCK RD	1928	Bungalow	1.5	Vinyl	Shingle - Composite		C
633 MURDOCK RD	1928	Colonial	2.5	Asbestos Shingle	Shingle - Composite	Detached	C
634 MURDOCK RD	1949	Cape Cod	1	Brick	Shingle - Composite		C
635 MURDOCK RD	1928	Bungalow	1.5	Vinyl	Shingle - Composite		C

United States Department of the Interior  
National Park Service

# National Register of Historic Places Continuation Sheet

BA-3200  
Anneslie Historic District

Name of Property

Baltimore County, MD

County and State

Section INVENTORY Page 19

Property Address	Year Built	Style	# of Stories	Ext. Constr.	Roofing	Garage Type	Notes
636 MURDOCK RD	1925	Cottage	1.5	Cedar Shingle Frame	Shingle - Composite	Detached	C
637 MURDOCK RD	1928	Cottage	2	Frame	Shingle - Composite	Detached	C
638 MURDOCK RD	1956	Bungalow	1.5	Vinyl	Shingle - Composite	Detached	C
639 MURDOCK RD	1933	Tudor	1.5	Brick	Shingle - Composite	Undergrnd/Bsmnt	C
640 MURDOCK RD	1924	Bungalow	1.5	Cedar Shingle	Shingle - Composite	Detached	C
700 MURDOCK RD	1926	Bungalow	1	Asbestos Shingle	Shingle - Composite	Detached	C
701 MURDOCK RD	1928	Bungalow	2	Asbestos Shingle	Shingle - Composite	Detached	C
702 MURDOCK RD	1928	Colonial	2.5	Vinyl	Shingle - Composite	Detached	C
703 MURDOCK RD	1928	Bungalow	2	Asbestos Shingle	Shingle - Composite		C
704 MURDOCK RD	1929	Bungalow	1.5	Asbestos Shingle	Shingle - Composite		C
705 MURDOCK RD	1928	Bungalow	1.5	Asbestos Shingle	Shingle - Composite		C
706 MURDOCK RD	1932	Bungalow	1.5	Asbestos Shingle	Shingle - Composite		C
707 MURDOCK RD	1928	Tudor	1.5	Vinyl	Shingle - Composite	Detached	C
708 MURDOCK RD	1933	Bungalow	1.5	Asbestos Shingle	Shingle - Composite	Detached	C
709 MURDOCK RD	1923	Cape Cod	1.5	Frame	Slate		C

United States Department of the Interior  
National Park Service

# National Register of Historic Places Continuation Sheet

BA-3200  
Anneslie Historic District  
Name of Property

Baltimore County, MD  
County and State

Section INVENTORY Page 20

Property Address	Year Built	Style	# of Stories	Ext. Constr.	Roofing	Garage Type	Notes
710 MURDOCK RD	1952	Cape Cod	1.5	Vinyl	Shingle - Composite		C
711 MURDOCK RD	1928	Colonial	2	Asbestos Shingle	Shingle - Composite	Attached	C
712 MURDOCK RD	1925	Cottage	1.5	Vinyl	Shingle - Composite	Detached	C
713 MURDOCK RD	1928	Cottage	1.5	Asbestos Shingle	Slate	Detached	C
714 MURDOCK RD	1939	Colonial	2	Brick	Slate	Attached	C
715 MURDOCK RD	1928	Bungalow	1.5	Asbestos Shingle	Shingle - Composite	Undergnd/Bsmnt	C
716 MURDOCK RD	1938	Cottage	2	Asbestos Shingle	Shingle - Composite	Detached	C
717 MURDOCK RD	1972	Colonial	2	Vinyl/Brick	Shingle - Composite		NC
718 MURDOCK RD	1940	Colonial	2	Brick	Shingle - Composite		C
719 MURDOCK RD	1943	Tudor	1.5	Brick	Shingle - Composite		C
720 MURDOCK RD	1941	Colonial	2	Brick	Brick/Vinyl		C
721 MURDOCK RD	1943	Tudor	1.5	Brick	Slate		C
722 MURDOCK RD	1941	Colonial	2	Vinyl	Shingle - Composite	Attached	C
723 MURDOCK RD	1925	Colonial	2	Wood	Shingle - Composite		C
724 MURDOCK RD	1941	Colonial	2	Brick	Slate		C

United States Department of the Interior  
National Park Service

# National Register of Historic Places Continuation Sheet

BA-3200  
Anneslie Historic District

Name of Property

Baltimore County, MD

County and State

Section INVENTORY Page 21

Property Address	Year Built	Style	# of Stories	Ext. Constr.	Roofing	Garage Type	Notes
725 MURDOCK RD	1951	Cape Cod	1.5	Vinyl	Shingle - Composite		C
727 MURDOCK RD	1951	Tudor	2	Brick	Shingle - Composite		C
500 OVERBROOK RD	1936	Colonial	2	Brick	Slate	Detached	C
501 OVERBROOK RD	1937	Tudor	2	Brick	Slate	Attached	C
502 OVERBROOK RD	1938	Colonial	2	Brick	Slate	Detached	Featured In 1932 newspaper ad C
503 OVERBROOK RD	1929	Colonial	2.5	Wood	Slate	Detached	C
504 OVERBROOK RD	1936	Tudor	2	Brick	Slate		C
505 OVERBROOK RD	1937	Tudor	2	Brick	Slate		C
506 OVERBROOK RD	1938	Tudor	2	Brick	Shingle - Composite	Attached	C
507 OVERBROOK RD	1936	Tudor	2	Brick	Slate	Attached	C
508 OVERBROOK RD	1938	Tudor	2	Brick		Attached	C
509 OVERBROOK RD	1937	Tudor	2	Brick	Slate	Attached	C
510 OVERBROOK RD	1938	Tudor	2	Brick	Slate	Attached	C
511 OVERBROOK RD	1937	Tudor	2	Brick	Slate	Attached	C
512 OVERBROOK RD	1935	Tudor	2	Brick	Shingle - Composite	Attached	C

United States Department of the Interior  
National Park Service

# National Register of Historic Places Continuation Sheet

BA-3200  
Anneslie Historic District  
Name of Property

Baltimore County, MD  
County and State

Section INVENTORY Page 22

Property Address	Year Built	Style	# of Stories	Ext. Constr.	Roofing	Garage Type	Notes
513 OVERBROOK RD	1935	Tudor	2	Brick	Shingle - Composite	Attached	C
514 OVERBROOK RD	1939	Tudor	2	Brick	Shingle - Composite	Attached	C
515 OVERBROOK RD	1935	Tudor	2	Brick	Shingle - Composite	Attached	C
516 OVERBROOK RD	1938	Tudor	2	Brick	Slate	Detached	C
517 OVERBROOK RD	1936	Tudor	2	Brick	Slate	Attached	C
518 OVERBROOK RD	1936	Tudor	2	Brick	Slate	Attached	C
519 OVERBROOK RD	1934	Tudor	2	Brick	Slate		C
520 OVERBROOK RD	1942	Colonial	2	Brick		Undergnd/Bsmnt	C
521 OVERBROOK RD	1936	Tudor	2	Brick	Slate	Attached	C
522 OVERBROOK RD	1938	Tudor	2	Brick		Undergnd/Bsmnt	C
523 OVERBROOK RD	1936	Tudor	2	Brick		Undergnd/Bsmnt	C
524 OVERBROOK RD	1938	Tudor	2	Brick	Slate	Attached	C
525 OVERBROOK RD	1934	Tudor	2	Brick	Shingle - Composite	Undergnd/Bsmnt	C
526 OVERBROOK RD	1934	Tudor	1.5	Brick	Slate		C
527 OVERBROOK RD	1934	Tudor	2	Brick	Slate	Undergnd/Bsmnt	C

United States Department of the Interior  
National Park Service

# National Register of Historic Places Continuation Sheet

BA-3200  
Anneslie Historic District

Name of Property

Baltimore County, MD

County and State

Section INVENTORY Page 23

Property Address	Year Built	Style	# of Stories	Ext. Constr.	Roofing	Garage Type	Notes
528 OVERBROOK RD	1938	Spanish	1	Stucco	Shingle - Composite	Detached	C
529 OVERBROOK RD	1931	Tudor	1.5	Wood	Shingle - Composite	Detached	C
530 OVERBROOK RD	1938	Tudor	2	Brick	Slate	Attached	C
531 OVERBROOK RD	1931	Colonial	2	Sliding	Shingle - Composite		C
532 OVERBROOK RD	1929	Cape Cod	1.5	Brick	Shingle - Composite	Detached	C
533 OVERBROOK RD	1931	Colonial	2.5	Sliding	Slate	Undergnd/Bsmnt	C
600 OVERBROOK RD	1937	Tudor	2	Brick	Slate	Attached	C
601 OVERBROOK RD	1938	Tudor	2	Brick	Slate	Attached	C
602 OVERBROOK RD	1938	Tudor	2	Brick	Shingle - Composite	Detached	C
603 OVERBROOK RD	1938	Colonial	2	Brick	Slate		C
604 OVERBROOK RD	1942	Colonial	2	Brick	Slate	Detached	C
605 OVERBROOK RD	1951	Colonial	2	Brick	Shingle - Composite	Undergnd/Bsmnt	C
606 OVERBROOK RD	1942	Colonial	2	Brick	Slate	Undergnd/Bsmnt	C
607 OVERBROOK RD	1940	Colonial	2	Stone	Slate	Built In	C
608 OVERBROOK RD	1942	Colonial	2	Brick	Shingle - Composite	Undergnd/Bsmnt	C



United States Department of the Interior  
National Park Service

# National Register of Historic Places Continuation Sheet

BA-3200  
Anneslie Historic District

Name of Property

Baltimore County, MD

County and State

Section INVENTORY Page 24

Property Address	Year Built	Style	# of Stories	Ext. Constr.	Roofing	Garage Type	Notes
609 OVERBROOK RD	1943	Colonial	2	Brick	Slate	Detached	C
610 OVERBROOK RD	1943	Colonial	2	Brick	Slate	Undergnd/Bsmnt	C
611 OVERBROOK RD	1941	Colonial	2	Brick	Slate	Detached	C
612 OVERBROOK RD	1940	Colonial	2	BRICK	Slate		C
613 OVERBROOK RD	1941	Colonial	2	Brick	Slate	Undergnd/Bsmnt	C
614 OVERBROOK RD	1942	Colonial	2	Brick	Slate	Undergnd/Bsmnt	C
615 OVERBROOK RD	1935	Colonial	2	Brick	Shingle - Composite	1 Car Detached	C
616 OVERBROOK RD	1942	Colonial	2	Brick	Shingle - Composite	Undergnd/Bsmnt	C
617 OVERBROOK RD	1950	Colonial	2	Brick	Slate		C
618 OVERBROOK RD	1942	Colonial	2	Brick	Shingle - Composite	Undergnd/Bsmnt	C
619 OVERBROOK RD	1952	Colonial	2	Brick	Slate		C
620 OVERBROOK RD	1942	Colonial	2	Brick	Slate	Undergnd/Bsmnt	C
621 OVERBROOK RD	1943	Colonial	2	Brick	Slate	Attached	C
622 OVERBROOK RD	1942	Colonial	2	Brick	Shingle - Composite	Undergnd/Bsmnt	C
623 OVERBROOK RD	1943	Colonial	2	Brick	Slate	Undergnd/Bsmnt	C

United States Department of the Interior  
National Park Service

# National Register of Historic Places Continuation Sheet

BA-3200  
Anneslie Historic District

Name of Property

Baltimore County, MD

County and State

Section INVENTORY Page 25

Property Address	Year Built	Style	# of Stories	Ext. Constr.	Roofing	Garage Type	Notes
624 OVERBROOK RD	1942	Colonial	2	Brick	Slate	Undergnd/Bsmnt	C
625 OVERBROOK RD	1943	Colonial	2	Brick	Slate	Detached	C
626 OVERBROOK RD	1942	Colonial	2	Brick	Shingle - Composite	Undergnd/Bsmnt	C
627 OVERBROOK RD	1948	Tudor	1.5	Brick	Shingle - Composite	Undergnd/Bsmnt	C
628 OVERBROOK RD	1942	Colonial	2	Brick	Shingle - Composite	Undergnd/Bsmnt	C
629 OVERBROOK RD	1950	Cape Cod	2	Brick	Shingle - Composite	Detached	C
630 OVERBROOK RD	1942	Colonial	2	Brick	Slate	Undergnd/Bsmnt	C
631 OVERBROOK RD	1950	Colonial	2	Brick	Shingle - Composite		C
632 OVERBROOK RD	1942	Colonial	2	Brick	Slate	Undergnd/Bsmnt	C
633 OVERBROOK RD	1950	Tudor	1.5	Brick	Shingle - Composite	Undergnd/Bsmnt	C
634 OVERBROOK RD	1942	Colonial	2	Brick	Slate	Undergnd/Bsmnt	C
635 OVERBROOK RD	1973	Cape Cod	2	Brick			NC
636 OVERBROOK RD	1942	Colonial	2	Brick	Slate	Undergnd/Bsmnt	C
637 OVERBROOK RD	1944	Colonial	2	Brick	Slate	Detached	C
638 OVERBROOK RD	1944	Colonial	2	Brick	Shingle - Composite		C

United States Department of the Interior  
National Park Service

# National Register of Historic Places Continuation Sheet

BA-3200  
Anneslie Historic District  
Name of Property

Baltimore County, MD  
County and State

Section INVENTORY Page 26

Property Address	Year Built	Style	# of Stories	Ext. Constr.	Roofing	Garage Type	Notes
639 OVERBROOK RD	1946	Colonial	2	Brick	Slate	Detached	C
700 OVERBROOK RD	1949	Rancher	1	Brick	Shingle - Composite	1 Car Attached	C
701 OVERBROOK RD	1949	Colonial	2	Siding	Shingle - Composite	Detached	C
703 OVERBROOK RD	1950	Tudor	1.5	Brick	Shingle - Composite	Undergnd/Bsmnt	C
704 OVERBROOK RD	1950	Contemporary Cape Cod	1.5	Brick	Shingle - Composite		C
705 OVERBROOK RD	1949	Tudor	1.5	Brick	Shingle - Composite	Undergnd/Bsmnt	C
706 OVERBROOK RD	1950	Contemporary Cape Cod	1.5	Brick	Shingle - Composite		C
707 OVERBROOK RD	1948	Cape Cod	1.5	Stone	Shingle - Composite		C
708 OVERBROOK RD	1951	Colonial	2	Siding & Brick	Shingle - Composite		C
709 OVERBROOK RD	1951	Cape Cod	1.5	Brick	Shingle - Composite		C
710 OVERBROOK RD	1949	Cape Cod	1.5	Siding	Shingle - Composite	Undergnd/Bsmnt	C
711 OVERBROOK RD	1951	Cape Cod	1.5	Brick	Shingle - Composite		C
712 OVERBROOK RD	1951	Cape Cod	1.5	Stucco	Shingle - Composite		C
713 OVERBROOK RD	1951	Cape Cod	1.5	Brick	Shingle - Composite		C
714 OVERBROOK RD	1948	Colonial	2	Brick	Shingle - Composite		C

United States Department of the Interior  
National Park Service

# National Register of Historic Places Continuation Sheet

BA-3200  
Anneslie Historic District

Name of Property

Baltimore County, MD

County and State

Section INVENTORY Page 27

Property Address	Year Built	Style	# of Stories	Ext. Constr.	Roofing	Garage Type	Notes
715 OVERBROOK RD	1949	Rancher	1	Siding	Shingle - Composite		C
716 OVERBROOK RD	1951	Cape Cod	1.5	Siding	Shingle - Composite		C
718 OVERBROOK RD	1946	Cottage	1	Stucco	Shingle - Composite		C
720 OVERBROOK RD	1947	Colonial	2	Brick	Shingle - Composite		C
722 OVERBROOK RD	1951	Cape Cod	1.5	Siding	Shingle - Composite		C
724 OVERBROOK RD	1947	Cape Cod	1.5	Brick	Shingle - Composite		C
726 OVERBROOK RD	1950	Cape Cod	1.5	Brick	Shingle - Composite		C
727 OVERBROOK RD	1954	Cape Cod	1.5	Brick	Shingle - Composite	Undergnd/Bsmnt	C
728 OVERBROOK RD	1950	Cape Cod	1.5	Asbestos Shingle	Shingle - Composite		C
729 OVERBROOK RD	1954	Cape Cod	1.5	Brick	Shingle - Composite	Undergnd/Bsmnt	C
730 OVERBROOK RD	1950	Cape Cod	1.5	Asbestos Shingle	Shingle - Composite		C
734 OVERBROOK RD	1949	Cape Cod	1.5	Siding	Shingle - Composite	Detached	C
501 REGESTER AVE	1923	Bungalow	1.5	Vinyl	Shingle - Composite	Detached	C
503 REGESTER AVE	1927	Colonial	2	Vinyl	Shingle - Composite	Detached	C
505 REGESTER AVE	1933	Cottage	1.5	Brick	Shingle - Composite	Undergnd/Bsmnt	C

United States Department of the Interior  
National Park Service

# National Register of Historic Places Continuation Sheet

BA-3200  
Anneslie Historic District

Name of Property

Baltimore County, MD

County and State

Section INVENTORY Page 28

Property Address	Year Built	Style	# of Stories	Ext. Constr.	Roofing	Garage Type	Notes
507 REGESTER AVE	1924	Foursquare	2.5	Vinyl	Shingle - Composite		C
509 REGESTER AVE	1924	Bungalow	1.5	Vinyl	Shingle - Composite	Detached	C
511 REGESTER AVE	1924	Foursquare	2	Vinyl	Shingle - Composite		C
513 REGESTER AVE	1927	Bungalow	1.5	Asbestos Shingle	Shingle - Composite	Detached	C
515 REGESTER AVE	1927	Colonial	2	Wood	Shingle - Composite	Detached	C
517 REGESTER AVE	1929	Foursquare	2.5	Frame	Shingle - Composite		C
519 REGESTER AVE	1928	Colonial	2.5	Frame	Slate	Detached	C
521 REGESTER AVE	1927	Cottage	1.5	Vinyl	Shingle - Composite	Detached	C
523 REGESTER AVE	1924	Bungalow	1.5	Vinyl	Shingle - Composite		C
525 REGESTER AVE	1934	Spanish	2	Stucco	Shingle - Composite		C
531 REGESTER AVE	1924	Bungalow	1.5	Vinyl	Shingle - Composite	Detached	C
533 REGESTER AVE	1924	Bungalow	1.5	Vinyl	Shingle - Composite	Detached	C
601 REGESTER AVE	1926	Bungalow	2	Cedar Shingle	Shingle - Composite	Detached	C
603 REGESTER AVE	1928	Bungalow	1.5	Vinyl	Shingle - Composite	Detached	C
605 REGESTER AVE	1922	Bungalow	1.5	Stone	Shingle - Composite	Detached	C

United States Department of the Interior  
National Park Service

# National Register of Historic Places Continuation Sheet

BA-3200  
Anneslie Historic District  
Name of Property

Section INVENTORY Page 29

Baltimore County, MD  
County and State

Property Address	Year Built	Style	# of Stories	Ext. Constr.	Roofing	Garage Type	Notes
607 REGESTER AVE	1926	Bungalow	1.5	Asbestos Shingle	Shingle - Composite		C
609 REGESTER AVE	1926	Bungalow	1.5	Asbestos Shingle	Shingle - Composite		C
611 REGESTER AVE	1926	Bungalow	1.5	Wood	Shingle - Composite		C
613 REGESTER AVE	1936	Tudor	2	Brick	Slate	Undergnd/Bsmnt	C
615 REGESTER AVE	1940	Colonial	2	Brick	Slate	Attached	C
617 REGESTER AVE	1937	Tudor	2	Brick	Slate		C
619 REGESTER AVE	1925	Bungalow	2	Vinyl Siding	Shingle - Composite	Detached	C
621 REGESTER AVE	1930	Dutch Colonial	2	Vinyl Siding	Shingle - Composite		C
623 REGESTER AVE	1928	Cottage	2	Frame	Shingle - Composite	Detached	C
625 REGESTER AVE	1928	Bungalow	1.5	vinyl	Slate		C
627 REGESTER AVE	1933	Tudor	2	Stucco	Shingle - Composite		C
629 REGESTER AVE	1931	Tudor	1.5	Stucco	Shingle - Composite		C
631 REGESTER AVE	1928	Dutch Colonial	2	Frame	Slate	Detached	C
633 REGESTER AVE	1925	Foursquare	2	Vinyl Siding	Shingle - Composite		C
635 REGESTER AVE	1926	Bungalow	1.5	Vinyl Siding	Shingle - Composite		C

United States Department of the Interior  
National Park Service

# National Register of Historic Places Continuation Sheet

BA-3200  
Anneslie Historic District

Name of Property

Baltimore County, MD

County and State

Section INVENTORY Page 30

Property Address	Year Built	Style	# of Stories	Ext. Constr.	Roofing	Garage Type	Notes
637 REGESTER AVE	1932	Tudor	1.5	Brick	Shingle - Composite	Undergnd/Bsmnt	C
639 REGESTER AVE	1928	Bungalow	1.5	Vinyl Sldng	Shingle - Composite	Detached	C
701 REGESTER AVE	1927	Bungalow	2	Stucco	Shingle - Composite	Detached	C
703 REGESTER AVE	1937	Colonial	2	Brick	Slate	Detached	C
705 REGESTER AVE	1928	Foursquare	2	Vinyl Sldng	Shingle - Composite	Detached	C
707 REGESTER AVE	1921	Colonial	2.5	vinyl	Shingle - Composite	Detached	C
709 REGESTER AVE	1941	Colonial	2	Brick	Slate		C
711 REGESTER AVE	1941	Colonial	2.5	Brick	Slate	Undergnd/Bsmnt	C
713 REGESTER AVE	1941	Colonial	2	Stone/ Asbestos Shingle	Slate	Undergnd/Bsmnt	C
715 REGESTER AVE	1940	Colonial	2	Brick	Slate		C
717 REGESTER AVE	1940	Colonial	2	Brick/ Asbestos Shingle	Shingle - Composite	Undergnd/Bsmnt	C
719 REGESTER AVE	1937	Tudor	2	Brick	Slate	Carport	C
721 REGESTER AVE	1914	Colonial	2	Vinyl Siding	Shingle - Composite	Detached	Predates period of significance NC
504 WINDWOOD RD	1952	Tudor	1.5	Brick	Shingle - Composite	Undergnd/Bsmnt	C
505 WINDWOOD RD	1952	Tudor	1.5	Brick	Shingle - Composite	Undergnd/Bsmnt	C

United States Department of the Interior  
National Park Service

# National Register of Historic Places Continuation Sheet

BA-3200  
Anneslie Historic District

Name of Property

Baltimore County, MD

County and State

Section INVENTORY Page 31

Property Address	Year Built	Style	# of Stories	Ext. Constr.	Roofing	Garage Type	Notes
506 WINDWOOD RD	1952	Colonial	2	Brick	Shingle - Composite	Detached	C
507 WINDWOOD RD	1952	Cape Cod	1.5	Brick	Shingle - Composite	Detached	C
508 WINDWOOD RD	1952	Cape Cod	1.5	Brick	Shingle - Composite		C
509 WINDWOOD RD	1951	Cape Cod	1.5	Vinyl	Shingle - Composite		C
510 WINDWOOD RD	1950	Colonial	2	Brick	Shingle - Composite		C
511 WINDWOOD RD	1951	Colonial	2	Brick	Shingle - Composite		C
512 WINDWOOD RD	1952	Cape Cod	1.5	Brick	Shingle - Composite	Detached	C
513 WINDWOOD RD	1956	Cape Cod	1.5	Brick	Shingle - Composite	Undergnd/Bsmnt	C
514 WINDWOOD RD	1950	Colonial	2	Brick	Slate		C
515 WINDWOOD RD	1948	Colonial	2	Brick	Slate	Attached	C
516 WINDWOOD RD	1951	Cape Cod	1.5	Brick	Shingle - Composite		C
517 WINDWOOD RD	1950	Tudor	1.5	Brick	Slate	Detached	C
518 WINDWOOD RD	1952	Colonial	2	Brick	Shingle - Composite		C
519 WINDWOOD RD	1952	Colonial	2	Brick	Tile		C
520 WINDWOOD RD	1952	Tudor	1.5	Brick	Shingle - Composite		C



United States Department of the Interior  
National Park Service

# National Register of Historic Places Continuation Sheet

BA-3200  
Anneslie Historic District  
Name of Property

Baltimore County, MD  
County and State

Section INVENTORY Page 32

Property Address	Year Built	Style	# of Stories	Ext. Constr.	Roofing	Garage Type	Notes
521 WINDWOOD RD	1950	Cape Cod	1.5	Brick	Shingle - Composite	Undergnd/Bsmnt	C
522 WINDWOOD RD	1952	Cape Cod	1.5	Brick	Shingle - Composite		C
523 WINDWOOD RD	1953	Cape Cod	1.5	Brick	Shingle - Composite		C
524 WINDWOOD RD	1952	Cape Cod	1.5	Brick	Shingle - Composite		C
525 WINDWOOD RD	1951	Tudor	1.5	Brick	Shingle - Composite		C
526 WINDWOOD RD	1952	Cape Cod	1.5	Brick	Shingle - Composite	Undergnd/Bsmnt	C
527 WINDWOOD RD	1950	Tudor	1.5	Brick	Shingle - Composite		C
528 WINDWOOD RD	1951	Cape Cod	1.5	Brick	Shingle - Composite	Undergnd/Bsmnt	C
529 WINDWOOD RD	1950	Colonial	2	Vinyl	Shingle - Composite		Extensively altered or rebuilt NC
530 WINDWOOD RD	1951	Cape Cod	1.5	Brick	Shingle - Composite		C
531 WINDWOOD RD	1952	Cottage	1.5	Brick	Shingle - Composite	Undergnd/Bsmnt	C
532 WINDWOOD RD	1950	Cottage	1.5	Brick	Shingle - Composite		C
600 WINDWOOD RD	1951	Tudor	1.5	Brick	Shingle - Composite		C
601 WINDWOOD RD	1952	Cape Cod	1.5	Brick	Shingle - Composite		C
602 WINDWOOD RD	1952	Cape Cod	1.5	Vinyl	Shingle - Composite	Undergnd/Bsmnt	C

United States Department of the Interior  
National Park Service

# National Register of Historic Places Continuation Sheet

BA-3200  
Anneslie Historic District

Name of Property

Baltimore County, MD

County and State

Section INVENTORY Page 33

Property Address	Year Built	Style	# of Stories	Ext. Constr.	Roofing	Garage Type	Notes
603 WINDWOOD RD	1961	Cape Cod	1.5	Brick	Shingle - Composite		C
604 WINDWOOD RD	1951	Colonial	2	Brick	Shingle - Composite	Built In	C
605 WINDWOOD RD	1954	Spllt foyer	2	Brick	Shingle - Composite		C
606 WINDWOOD RD	1951	Tudor	1.5	Brick	Shingle - Composite	Undergnd/Bsmnt	C
608 WINDWOOD RD	1948	Cape Cod	1.5	Brick	Shingle - Composite		C
610 WINDWOOD RD	1952	Cape Cod	1.5	Stucco	Shingle - Composite	Detached	C
612 WINDWOOD RD	1950	Cape Cod	1.5	Stucco	Shingle - Composite	Detached	C
614 WINDWOOD RD	1957	Spllt level	2	Stucco	Shingle - Composite	Built In	C
616 WINDWOOD RD	1953	Modern	1	Brick	Shingle - Composite	Carport	C
Harry Little 6811 YORK RD	1935	Commercial	1	Brick			C
6807 YORK RD	1922	Commercial	2	Brick			Extensively altered in the Late 20 <sup>th</sup> century NC
Stone York 6803-05 YORK RD	1952	Commercial	2	Brick			C
Ayd Hardware 6801 YORK RD	1923	Commercial	1	Brick			C
6729 YORK RD	1940	Colonial Commercial	1	Brick			C
6705-21 YORK RD	1947	Commercial	2	Brick			C

United States Department of the Interior  
National Park Service

# National Register of Historic Places Continuation Sheet

BA-3200  
Anneslie Historic District

Name of Property

Baltimore County, MD

County and State

Section INVENTORY Page 34

Property Address	Year Built	Style	# of Stories	Ext. Constr.	Roofing	Garage Type	Notes
CHAT 6701 YORK RD	1925	Foursquare	2.5	Brick	Slate		C
6609 YORK RD	1941	Tudor	1.5	Brick	Slate		C
6607 YORK RD	1967	Modern	2				NC
6603 YORK RD	1985	Modern	2				NC
6601 YORK RD	1940	Colonial	2				Extensively altered NC
6509 YORK RD	1951	Colonial	1.5				Extensively altered NC
6507 YORK RD	1933	Tudor	2				C
6505 YORK RD	c. 1965	Modern	2				NC
6503 YORK RD	1938	Tudor	2				C
6501 YORK RD	1973	Modern	2				NC

United States Department of the Interior  
National Park Service

# National Register of Historic Places Continuation Sheet

BA-3200  
Anneslie Historic District

---

Name of Property

Baltimore County, MD

---

County and State

Section PHOTO Page 1

## Index to Photographs

The following information applies to all photographs which accompany this documentation:

Maryland Inventory of Historic Properties (MIHP) Number: BA-3200  
Name of Property: Anneslie Historic District  
Location: Baltimore County, Maryland  
Photographer: Peter Kurtze  
Date taken: September 2011  
Location of original digital files: MD SHPO

### Photo captions:

MD\_BaltimoreCounty\_AnneslieHistoricDistrict\_0001.tif  
Villa Anneslie, 529 Dunkirk Rd

MD\_BaltimoreCounty\_AnneslieHistoricDistrict\_0002.tif  
Dunkirk Rd, 632 in foreground

MD\_BaltimoreCounty\_AnneslieHistoricDistrict\_0003.tif  
704, 705 Murdock Rd

MD\_BaltimoreCounty\_AnneslieHistoricDistrict\_0004.tif  
6701 York Rd

MD\_BaltimoreCounty\_AnneslieHistoricDistrict\_0005.tif  
730 Anneslie Rd

MD\_BaltimoreCounty\_AnneslieHistoricDistrict\_0006.tif  
606 Anneslie Rd

MD\_BaltimoreCounty\_AnneslieHistoricDistrict\_0007.tif  
725 Anneslie Rd

MD\_BaltimoreCounty\_AnneslieHistoricDistrict\_0008.tif  
628 Anneslie Rd

United States Department of the Interior  
National Park Service

# National Register of Historic Places Continuation Sheet

BA-3200  
Anneslie Historic District

---

Name of Property

Baltimore County, MD

---

County and State

Section PHOTO Page 2

---

MD\_BaltimoreCounty\_AnneslieHistoricDistrict\_0009.tif  
600 block Anneslie Rd, north side, view to west

MD\_BaltimoreCounty\_AnneslieHistoricDistrict\_0010.tif  
Register Ave, south side, view west from 617

MD\_BaltimoreCounty\_AnneslieHistoricDistrict\_0011.tif  
600 block Overbrook Rd, north side

MD\_BaltimoreCounty\_AnneslieHistoricDistrict\_0012.tif  
Commercial building (1935), 6811 York Rd

MD\_BaltimoreCounty\_AnneslieHistoricDistrict\_0013.tif  
York Rd, east side, view north from 6701

5A-540 BALTIMORE COUNTY, MD ANNESLIE HISTORIC DISTRICT  
NR BOUNDARIES CORRESPOND TO ORIGINAL (1925) PLAT

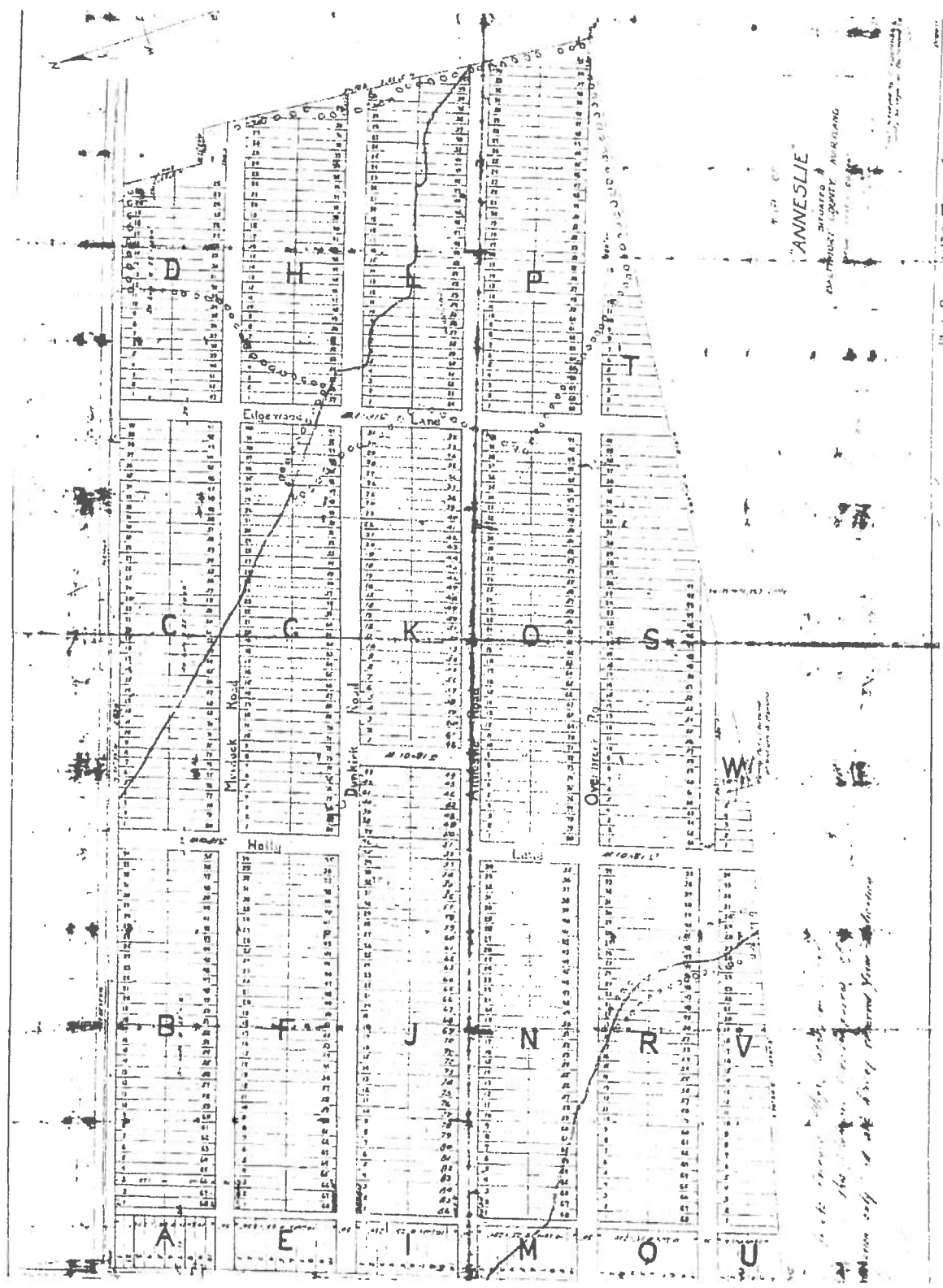

ANNESLIE PLAT DATED 1922/05/25  
BALTIMORE COUNTY PLAT BOOK WPC7, p. 40  
MSA C2136-4262, p.1

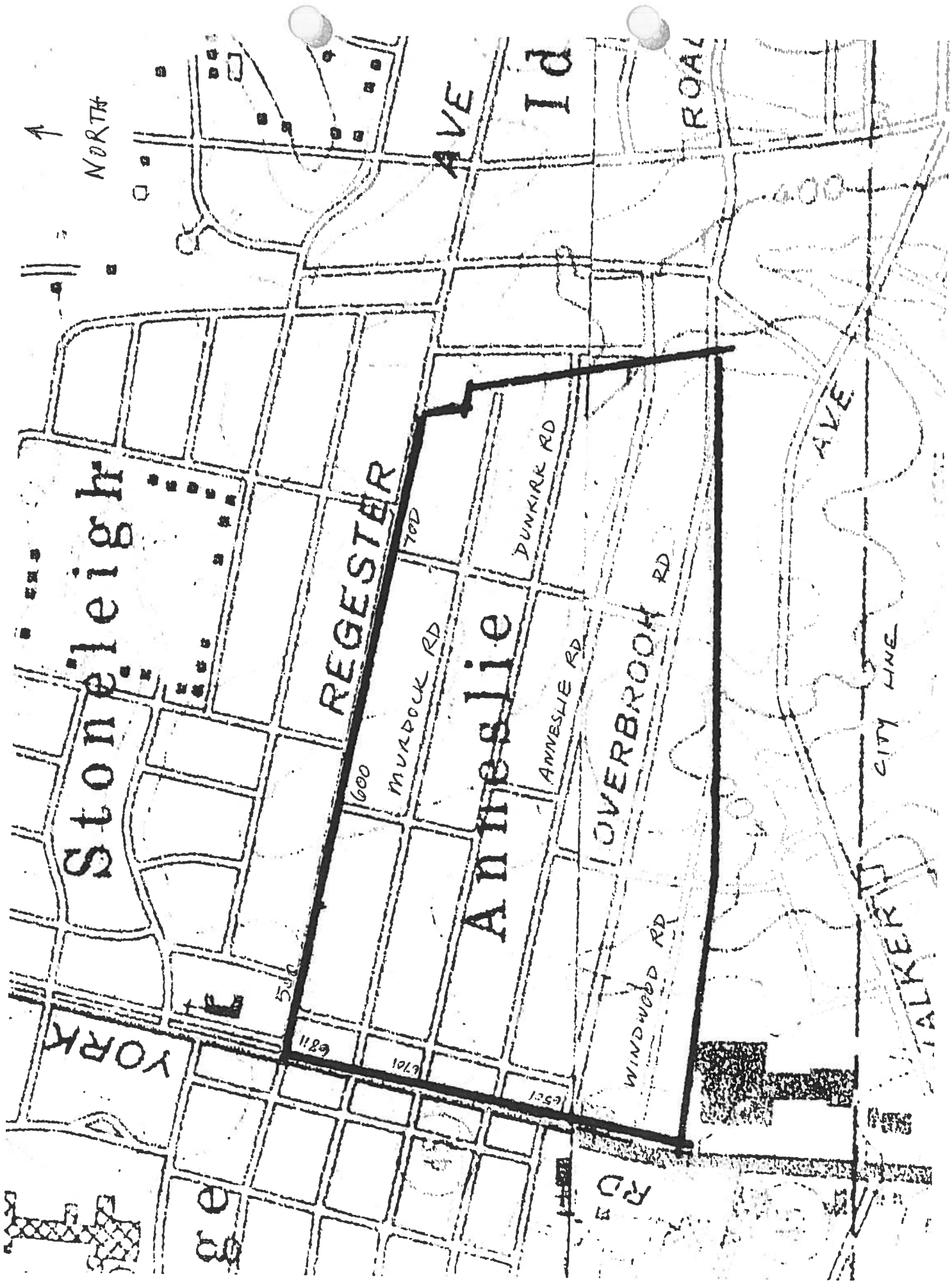

BA-3200 BALTIMORE COUNTY, MD ANNESHE HISTORIC DISTRICT NR BALTIMORE MAP 10/15/11

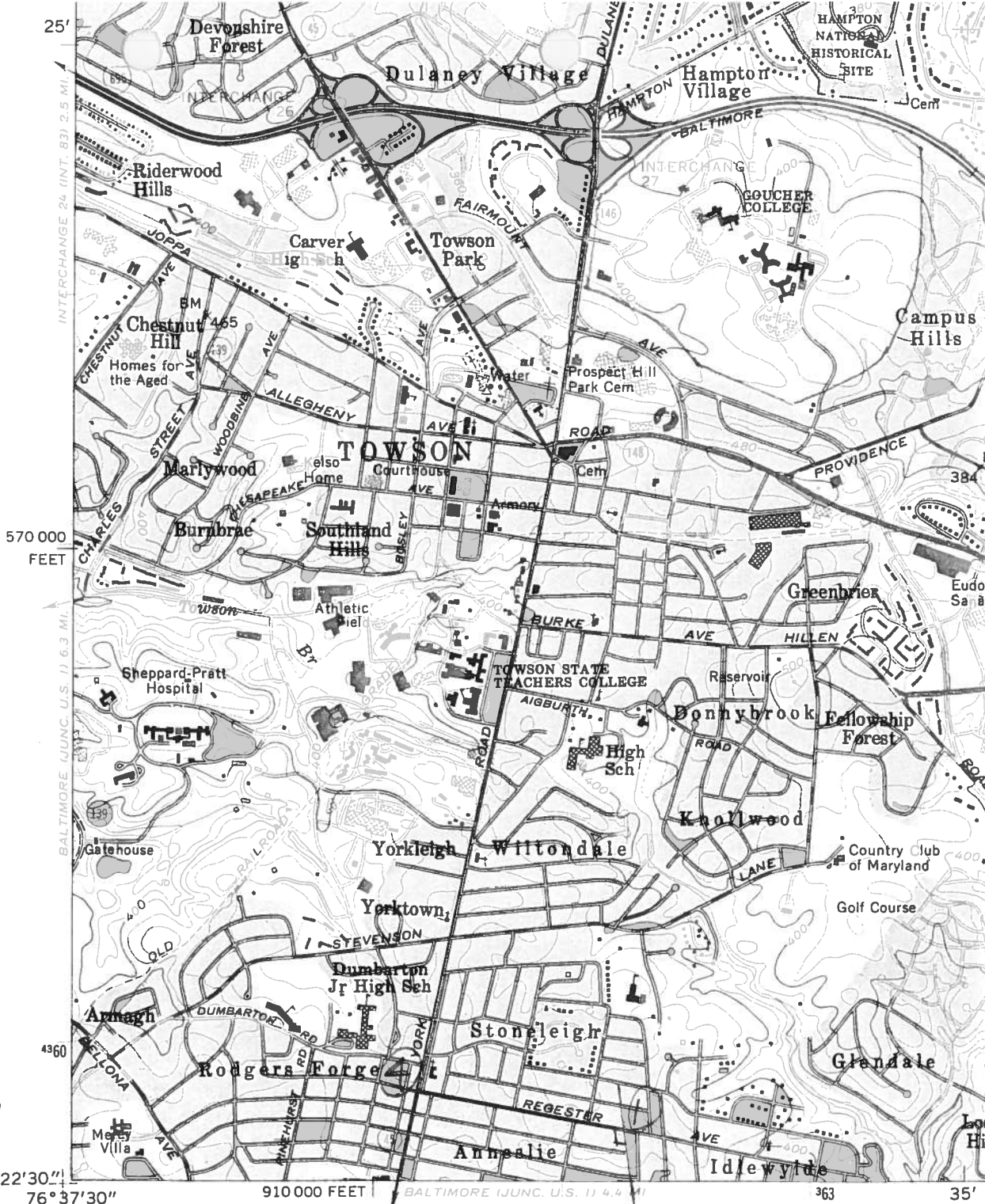

BA-3200  
ANNESLIE  
HISTORIC  
DISTRICT  
BALTIMORE  
COUNTY, MD

1:18-362282-  
4359823  
BALTIMORE WEST  
5562 SW

4:18-361466-  
4359995

TOWSON, MD  
QUAD

Mapped by the Army Map Service  
Edited and published by the Geological Survey  
Control by USGS, USC&GS, USCE, and Maryland  
Bureau of Control Surveys and Maps

Culture and drainage in part compiled from aerial photographs  
taken 1943. Topography by planetable surveys 1944  
Culture revised by the Geological Survey 1957

Polyconic projection. 1927 North American datum  
10,000-foot grid based on Maryland coordinate system  
1000-metre Universal Transverse Mercator grid ticks,  
zone 18, shown in blue

Red tint indicates areas in which only  
landmark buildings are shown

Revisions shown in purple compiled by the Geological Survey from  
aerial photographs taken 1966 and 1974. This information not  
field checked

Purple tint indicates extension of urban areas

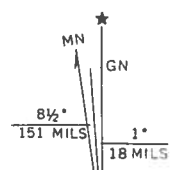

UTM GRID AND 1974 MAGNETIC NORTH  
DECLINATION AT CENTER OF SHEET



UNITED STATES  
DEPARTMENT OF THE INTERIOR  
GEOLOGICAL SURVEY

5682 (NW  
COCKEYSVILLE)

76°37'30"

39°22'30"

361000m. E.

TOWSON 17 MI

362

363

35'

2: 18-362347-  
4359462  
1: 18-361351-  
4359506  
3-3200  
ANNESLIE  
HISTORIC  
DISTRICT  
BALTIMORE  
COUNTY, MD

BALTIMORE EAST,  
MD ROAD

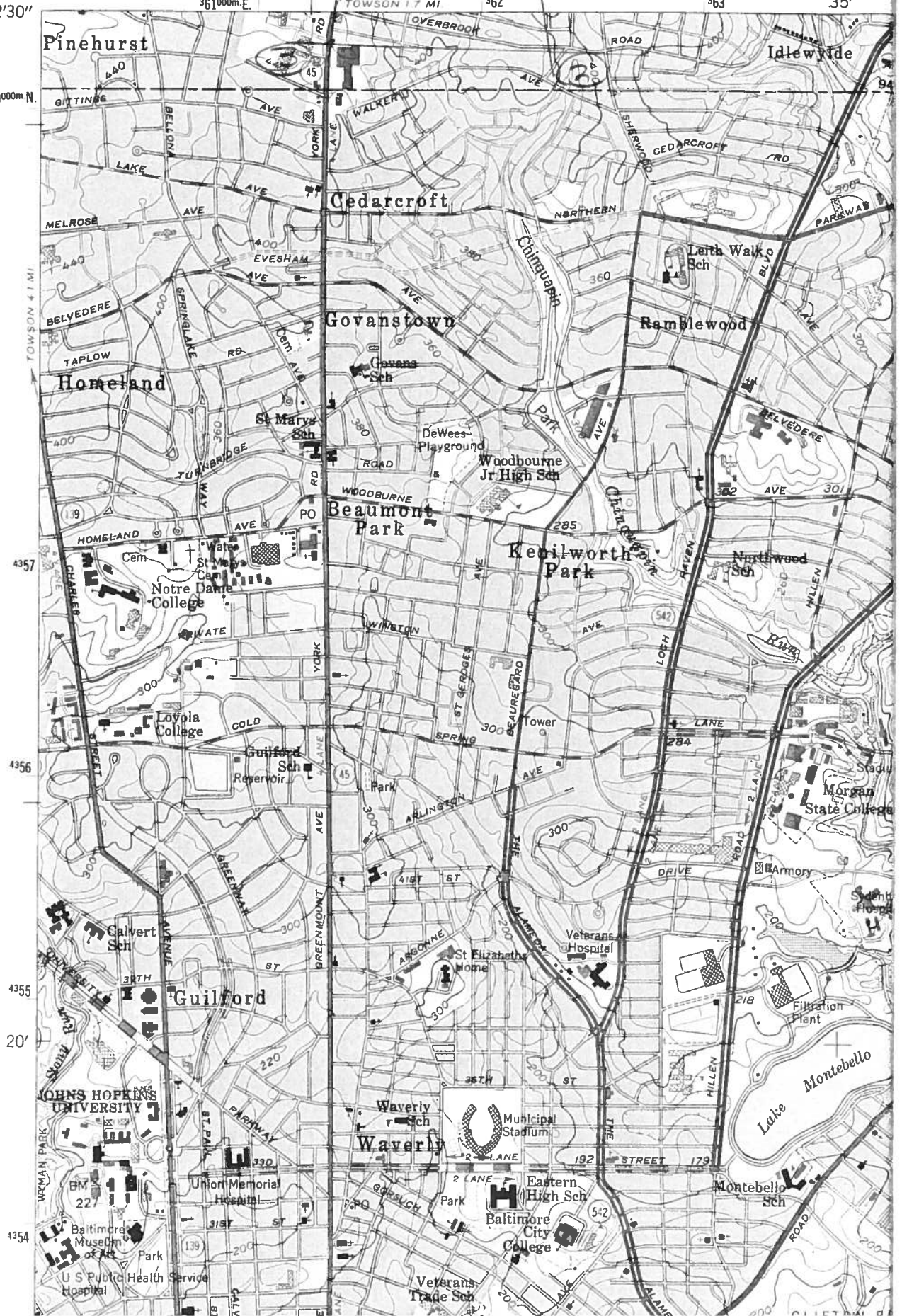

4359000m. N.  
TOWSON 41 MI  
4357  
4356  
4355  
20'  
4354